

CERTIFICATE OF SERVICE

***MICHAEL J. KORMAN v.
ILLINOIS DEPARTMENT OF TRANSPORTATION,
PCB 2021-006 (Citizen)***

I, MICHAEL J. KORMAN, a Citizen of the Village of Glenview, the County of Cook and the State of Illinois, do certify that I caused a true and correct copy of the attached Second Complainant's Reply to a Demand for a Bill of Particulars in the above-referenced matter with the Clerk of the Illinois Pollution Control Board, a copy of which is attached hereto and herewith served upon you via e-mail, on this September 22, 2020.

By: 
MICHAEL J. KORMAN
Citizen of the Village of
Glenview, the County of
Cook & the State of Illinois
2306 Sundrop Drive
Glenview, IL. 60026
(312) 600-1820
mike.korman@swpppaudit.com

SERVICE LIST

ARLENE R. HAAS
Assistant Attorney General
Environmental Bureau North
Office of the Illinois Attorney General
69 W. Washington Street, Suite 1800
Chicago, IL 60602 (312) 814-3153
Primary: ahaas@atg.state.il.us
Secondary: mcaacaccio@atg.state.il.us

BRAD HALLORAN
Hearing Officer
Illinois Pollution Control Board
James R. Thompson Center
100 West Randolph, Suite 11-500
Chicago, Illinois 60601
Email: Brad.Halloran@illinois.gov

BEFORE THE ILLINOIS POLLUTION CONTROL BOARD

MICHAEL J. KORMAN,

Complainant,

vs.

ILLINOIS DEPARTMENT OF
TRANSPORTATION,

Respondent

Case No.: PCB 2020-062

(CITIZENS ENFORCEMENT – NPDES,
WATER)

SECOND COMPLAINANT RESPONSE TO DEMAND FOR BILL OF PARTICULARS

FORMAL COMPLAINT

NOW COMES the Complainant, Michael J. Korman, pursuant to the Illinois Environmental Protection Act (415 ILCS 5), and 35 Ill. Admin. Code § 103.200, and for its Complaint against the ILLINOIS DEPARTMENT OF TRANSPORTATION, states as follows:

BACKGROUND INFORMATION

1. The Illinois Department of Transportation (“IDOT”) filed a Notice of Intent with the Illinois Environmental Protection Agency (“IEPA”) for the project identified as IDOT Contract 60N83. Mar '19 Letting Item 4. SN-016-0533 Carrying Willow Road on May 08, 2019. (Exhibit A, marked ‘A’) in accordance with (“IAW”) the General National Pollutant Discharge Elimination System (“NPDES”) Permit No. ILR10 which has an Issue and Effective Date of August 3, 2018 and an Expiration Date of July 31, 2023.
2. Under Part IV Storm Water Pollution Prevention Plans of the ILR10 Per Number 1 above Sub-section B.6: All storm water pollution prevention plans and all completed

1 inspection forms/reports required under this permit are considered reports that shall be
2 available to the public at any reasonable time upon request.

- 3 3. IEPA issued NPDES No. ILR10AV06 for IDOT Contract 60N83, Mar '19 Letting
4 Item 4, SN-016-0533 Carrying Willow Road. The Permit Coverage Date is shown as
5 June 18, 2019 Exhibit A, marked 'C'. The project is listed as 3.5000 acres which
6 exceeds the one-acre disturbed soil standard for requiring an NPDES Permit.
7
- 8 4. As shown on Exhibit B, the project is located immediately adjacent to the Kent Fuller
9 Air Station Prairie, a 32-acre tall-grass prairie which includes rare native vegetation,
10 over 160 plant species native to the area and supports unique wildlife including Red-
11 Tailed Hawks, many varieties of finches and crayfish.
12
- 13 5. As shown on Exhibit C, the project is located nearby to the Techny Basin, a 48.90 acre
14 Prairie with Wet and Dry-Bottom Detention features and is a Sub-watershed of the
15 West Fork of the North Branch of the Chicago River.
16
- 17 6. The Village of Glenview ("Glenview") participates in the National Flood Insurance
18 Program ("NFIP") Community Rating System, a voluntary incentive program that
19 recognizes and encourages community floodplain management activities that exceed
20 minimum NFIP requirements.
21
- 22 7. Glenview has experienced severe flooding events over the course of the last 20 years
23 resulting in many millions of dollars in damage, mitigation strategies and repairs that
24 continue today.
- 25 8. These complaints are brought on behalf of Complainant, Michael J. Korman, Citizen
26 of the Village of Glenview, County of Cook and State of Illinois against Respondent,
27
28

1 pursuant to the terms and provisions of the Illinois Environmental Protection Act
2 (“Act”), 415 ILCS 5 (2018).

3 9. At all times relevant to the Complaint, Respondent was and is a Department of the
4 State of Illinois Executive Branch.

5
6 10. Respondent’s principal office is Illinois Department of Transportation Hanley
7 Building 2300 S. Dirksen Parkway Springfield, IL 62764.

8 11. Respondent is funding and managing the project known as IDOT Contract 60N83.
9 Mar ’19 Letting Item 4. SN-016-0533 Carrying Willow Road. This project is also
10 known as: Federal Project # NHPPH84D(514) and State Job # C-91-407-11.

11
12 12. Section 402 of the federal Clean Water Act (“CWA”), 33 U.S.C. § 1342, establishes
13 the National Pollutant Discharge Elimination System (“NPDES”) program to address
14 water pollution by regulating point sources that discharge pollutants to the waters of
15 the United States.

16
17 13. Section 12(a) of the Act, 415 ILCS 5/12(a) (2018), provides as follows:

18 No person shall:

19 * * *

20 Cause or threaten or allow the discharge of any contaminants into the environment in
21 any state so as to cause or tend to cause water pollution in Illinois, either alone or in
22 combination with matter from other sources, or so as to violate regulations or
23 standards adopted by the Pollution Control Board under this act.

24 14. Section 12(f) of the Act, 415 ILCS 5/12(f) (2018), provides as follows:

25 No person shall:

26 * * *

27 Cause, threaten or allow the discharge of any contaminant into the waters
28

1 of the State, as defined herein, including but not limited to, waters to any
2 sewage works, or into any well or from any point source within the State,
3 without an NPDES permit for point source discharges issued by the Agency under
4 Section 39(b) of this act, or in violation of any term or condition imposed by such
5 permit, or in violation of any NPDES permit filing requirements established under
6 Section 39(b), or in violation of any regulations adopted by the Board or of any
7 order adopted by the Board with respect to the NPDES program.

8 15. Section 309.102(a) of the Illinois Pollution Control Board ("Board") Water Polluting
9 Regulations, 35 Ill. Adm. Code 302.102(a), provides as follows:

10 Except as in compliance with provisions of the Act, Board Regulations, and the
11 CWA, and the provisions and conditions of the NPDES permit issued to the
12 discharger, the discharge of any contaminant or pollutant by any person into the
13 waters of the State from a point source or into a well shall be unlawful.

14 16. Section 3.315 of the Act, 415 ILCS 5/3.315 (2018), provides the following definition:

15 "Person" means any individual, partnership, co-partnership, firm, company,
16 limited liability company, corporation, association, joint stock company, trust,
17 estate, political subdivision, state agency, or any other legal entity, or their legal
18 representative, agent or assigns.

19 17. Respondent, a State Agency, is a "person" as that term is defined in Section 3.315 of
20 the Act, 415 ILCS 5/3.315 (2018).

21 18. Section 3.170 of the Act, 415 ILCS 5/3.170 (2018), provides the following definition:

22 Contamination; contaminate. "Contamination" or "contaminate", when used in
23 connection with groundwater, means water pollution of such groundwater.

24 19. Stormwater Pollution discharged from the construction site at the Facility is a

25 "contaminant," as that term is defined by Section 3.170 of the Act, 415 ILCS 5/3.170
26 (2018).

27 20. Section 3.550 of the Act, 415 ILCS 5/3.550 (2018), provides the following definition:
28

1 “Waters” means all accumulations of water, surface and underground, natural,
2 and artificial, public and private, or parts thereof, which are wholly or partially
3 within, flow through, or border upon the State.

4 21. In Illinois, the Illinois EPA (“IEPA”) is the delegated responsible agency for
5 implementation of the NPDES program and federal regulations promulgated
6 thereunder.

7 22. Section 401.11(d) of the Code of Federal Regulations (“C.F.R.”), 40 C.F.R. 401.11(d),
8 provides as follows:
9

10 The term point source means any discernible, confined and discrete conveyance,
11 including but not limited to any pipe, ditch, channel, tunnel, conduit, well,
12 discrete fissure, container, rolling stock, concentrated animal feeding operation, or
13 vessel or other floating craft, from which pollutants are or may be discharged.

14 **COUNT 1**

- 15
- 16 1. Respondent is required to have an NPDES permit for discharges of stormwater
17 pollution at the Facility pursuant to Section 12(f) of the Act, 415 ILCS 5/12(f) 2018.
 - 18 2. The IEPA reports a Notice of Intent Submitted Date of May 8, 2019 and a Received
19 date of May 14, 2019 for the permit covering the aforementioned project which is
20 Permit # ILR10AV06. The IEPA issued Permit Coverage date is listed as June 18,
21 2019.
 - 22 3. By violating 35 Ill. Adm. Code 309.103, a regulation adopted by the Board and
23 NPDES Permit Standard Condition 2, Respondent thereby violated Sections 12(a)
24 and 12(f) of the Act, 415 ILCS 5/12(a) and 12(f) (2018), and section 309.102(a) of
25 the Board Water Pollution Regulations, 35 Ill. Adm. Code 309.102(a).
26
27
28

- 1 4. By discharging without a permit from May 20, 2019 through June 17, 2019, the day
2 before the NPDES Permit Coverage date, Respondent discharged Stormwater
3 Pollution without an NPDES Permit in violation of Section 12(f) of the Act, 415
4 ILCS 5/12(f).
5
- 6 5. IAW NPDES Permit No. ILR10AV06 under Part II Notice of Intent Requirements
7 Subsection A.1; IDOT violated the terms of the permit by authorizing or allowing the
8 General Contractor to begin construction of this project on May 20, 2019. As noted
9 in Exhibit A #C, the permit coverage date is shown as June 18, 2019. On August 20,
10 2020, Complainant submitted a Freedom of Information Act (“FOIA”) (Exhibit D) to
11 the Respondent’s FOIA Office. Respondent FOIA office responded to Complainant
12 on August 31, 2020, the first of two responses as of this date, which included a
13 Weekly Report (Exhibit E). Page 2 of 3 of the Weekly Report specifically states,
14 General Contractor “is scheduled to start the project on May 20th, 2019. In addition,
15 IDOT issued a Press Release on May 22, 2019 (Exhibit F) that work “will begin this
16 week.” The Weekly Report shows work was done on seventeen (17) days from May
17 21, 2019 to June 15, 2019. There is a gap in reporting on Complainant’s FOIA
18 request from June 16, 2019 through June 22, 2019 but Complainant would presume
19 that, weather permitting, there was work completed from June 17 through June 18,
20 2020 (2 additional days) until the permit went into effect on June 18, 2019. In this
21 case IDOT and their General Contractor were completing construction which should
22 have been covered by an NPDES permit but, in fact, worked without a permit. This
23 constitutes a lack of permit coverage for twenty-eight (28) days, further under 415
24 ILCS 5/12(f): No person shall Cause, threaten or allow the discharge of any
25
26
27
28

1 contaminant into the waters of the State, as defined herein, including but not limited
2 to, waters to any sewage works, or into any well or from any point source within the
3 State, without an NPDES permit for point source discharges issued by the Agency
4 under Section 39(b) of this Act, or in violation of any term or condition imposed by
5 such permit, or in violation of any NPDES permit filing requirement established
6 under Section 39(b), or in violation of any regulations adopted by the Board or of any
7 order adopted by the Board with respect to the NPDES program.
8

9 WHEREFORE, Complainant, MICHAEL J. KORMAN, respectfully requests the Board enter an
10 order against Respondent, ILLINOIS DEPARTMENT OF TRANSPORTATION, with respect to
11

12 Count 1:

- 13 1. Authorizing a hearing in this matter at which time Respondent will be required to
14 answer the allegations herein;
- 15 2. Finding that Respondent has violated Sections 12(a) and 12(f) of the Act, 415 ILCS
16 5/12(a) and 12(f) (2018), Sections 309.102(a), and 309.103 of the Board Water
17 Pollution Regulations, 35 Ill. Adm. Code 309.102(a) and 309.103, and NPDES
18 Standard Condition No. 2;
- 19 3. Ordering Respondent to cease and desist from any further violations of Section 12(a)
20 and 12(f) of the Act, 415 ILCS 5/12(a) and 12(f) (2018), Sections 309.102(a) and
21 309.103, and NPDES Standard Condition No. 2;
- 22 4. Assessing against Respondent a civil penalty of Fifty Thousand Dollars (\$50,000.00)
23 for each of violation of Section 12(a) of the Act, 415 ILCS 5/12(a) (2018), Sections
24 309.102(a) and 309.103 of the Board Water Pollution Regulations, 35 Ill. Adm. Code
25 309.102(a) and 309.104(a), and NPDES Standard Condition No. 2, and an additional
26
27
28

1 civil penalty of Ten Thousand Dollars (\$10,000.00) for each day of violation; or a
2 total of Three-hundred and Twenty Thousand Dollars (\$330,000.00).

- 3
4 5. Assessing against Respondent a civil penalty of Ten Thousand Dollars (\$10,000.00)
5 for each day of violation of Section 12(f) of the Act, 415 ILCS 5/12(f) (2018); or a
6 total of Two-hundred and Seventy Thousand Dollars (\$280,000.00).
- 7 6. Requiring Respondent to file an Incident of Noncompliance as it relates to Count 1 as
8 required as part of the NPDES Permit program for this project.
- 9 7. Granting such other relief as the Board deems appropriate and just.

10
11 **COUNT 2**

12 The NPDES Permit Application submitted to the IEPA intended to cover the aforementioned
13 project was deficient in the following manner:

- 14 1. Violation #1: IAW NPDES Permit No. ILR10AV06 Part IV B.5 the copy of a 'letter
15 of notification coverage' and the 'General NPDES Permit for Storm Water
16 Discharges from Construction Site Activities' shall be posted at the site in a
17 prominent place for public viewing. These documents are not posted.
- 18 2. Violation #2: IAW NPDES Permit No. ILR10AV06 Part IV D.1.e as part of the
19 Stormwater Pollution Prevention Plan ("SWPPP") submission, as required, the
20 SWPPP submitted to IEPA lacks a 'site map indicating drainage patterns and
21 approximate slopes anticipated before and after major grading activities, locations
22 where vehicles enter or exit the site and controls to offsite sediment tracking, areas of
23 soil disturbance, the location of major structural and nonstructural controls identified
24 in the plan, the location of area where stabilization practices are expected to occur,
25 locations of on-site or off-site soil stockpiling or material storage'.
26
27
28

- 1 3. Violation #3: IAW NPDES Permit No. ILR10AV06 Part IV D.2: The application is
2 missing 'details or drawings that show proper installation of controls and BMPs. The
3 Illinois Urban Manual (<http://www.aiswcd.org/illinois-urban-manual/>) or other similar
4 documents shall be used for developing the appropriate management practices,
5 controls or revisions of the plan. The plan will clearly describe for each major activity
6 identified in paragraph D.1 above, appropriate controls and the timing during the
7 construction process that the controls will be implemented.'
- 8
9 4. Violation #4: IAW NPDES Permit No. ILR10AV06 Part IV D.2.c.ii.b: While
10 respondent HAS initiated demolition and construction operations at the project site
11 they have NOT installed any storm drain inlet protection at any of the MS4 storm
12 inlets on Patriot Blvd. (runs beneath Willow Road and bridge project) as indicated in
13 the Illinois Urban Manual, specifically IUM-561D (or equivalent). The storm inlets
14 filters on Willow Road are either missing or have not been properly maintained.
- 15
16 5. Violation #5: IAW NPDES Permit No. ILR10AV06 Part IV D.2.f and g are
17 substantially non-compliant with a focus on g.iii (identify and include appropriate
18 controls for receiving concrete and asphalt) and g.iv (spill response procedures),
19 missing in its entirety.
- 20
21 6. Violation #6: IAW NPDES Permit No. ILR10AV06 Part IV D.2.h Best Management
22 Practices for Post-Construction Storm Water Management is missing in its entirety.
- 23
24 7. Violation #7: IAW NPDES Permit No. ILR10AV06 Part IV F.1 SWPPP must clearly
25 identify for each measure identified in the plan, the contractor(s) or subcontractor(s)
26 that will implement the measure is missing in its entirety.
- 27
28

1 8. Violation #8: IAW NPDES Permit No. ILR10AV06 Part IV D.2.f as stated “The
2 permittee shall design, install, implement, and maintain effective pollution prevention
3 measures to minimize the discharge of pollutants” is missing.

4
5 9. Violation #9: IAW NPDES Permit # ILR10AV06 Part II D.2: Complainant failed to
6 submit a copy of the signed NOI and appropriate fee by registered or certified
7 mail, return receipt requested, to the Agency at the address above. See Exhibit G
8 which Complainant received in response to a Freedom of Information Act request to
9 the IEPA on September 14, 2020 and received from IEPA on September 16, 2020.

10 WHEREFORE, Complainant, MICHAEL J. KORMAN, respectfully requests the Board enter an
11 order against Respondent, ILLINOIS DEPARTMENT OF TRANSPORTATION, with respect to
12

13 Count 2:

- 14 1. Authorizing a hearing in this matter at which time Respondent will be required to
15 answer the allegations herein;
- 16 2. Finding that Respondent has violated 12(f) of the Act, 415 ILCS 12(f) (2018),
17 Sections 309.102(a), and 309.103 of the Board Water Pollution Regulations, 35
18 Ill. Adm. Code 309.102(a) and 309.103, and NPDES Standard Condition No. 2;
- 19 3. Ordering Respondent to cease and desist from any further violations of Section
20 12(f) of the Act, 415 ILCS 12(f) (2018), Sections 309.102(a) and 309.103, and
21 NPDES Standard Condition No. 2;
- 22 4. Assessing against Respondent a civil penalty of Fifty Thousand Dollars
23 (\$50,000.00) for each of violation of Section 12(f) of the Act, 415 ILCS 5/12(f)
24 (2018), Sections 309.102(a) and 309.103 of the Board Water Pollution
25 Regulations, 35 Ill. Adm. Code 309.102(a) and 309.104(a), and NPDES Standard
26
27
28

1 Condition No. 2, and an additional civil penalty of Ninety Dollars (\$90,000.00)
2 for each noted violation; or a total of One-hundred and Forty Thousand Dollars
3 (\$140,000.000).
4

- 5 5. Requiring the Respondent to develop a fully compliant SWPPP plan for this
6 project to bring the project into compliance with Clean Water Act regulations.
7 6. Requiring Respondent to file an Incident of Noncompliance as it relates to Count
8 2 as required as part of the NPDES Permit program for this project.
9 7. Granting such other relief as the Board deems appropriate and just.
10

11 **COUNT 3**

12 The NPDES Permit requires periodic and rain event inspections, many of which are missing:

- 13 1. Respondent failed to complete one or more inspections require IAW NPDES Permit
14 No. ILR10AV06 Part IV D.4 Inspections
15 2. On August 20, 2020, Complainant submitted a Freedom of Information Act (“FOIA”)
16 (Exhibit D) to the Respondent’s FOIA Office. Respondent FOIA office provided to
17 Complainant, on September 11, 2020, the second of two responses as of this date,
18 which included thirty-four (34) Storm Water Pollution Prevention Plan Erosion
19 Control Inspection Reports (IDOT Form # BC 2259 (Rev. 05/15/09)).
20 3. These inspections are required ‘at least once every seven calendar days and within 24
21 hours of the end of a storm or by the end of the following business or workday that is
22 0.50 inches or greater’.
23 4. For the Weekly Reports, assuming a start date of May 21, 2019 (as noted in Count 1)
24 there should be 66 weekly reports through to the FOIA response date of August 20,
25 2020. IAW the same sub-section, ‘Inspections may be reduced to once per month
26
27
28

1 when construction activities have ceased due to frozen conditions.’ Based on a review
2 of the weekly reports referenced in #2 (in Count #2) the general contractor did not
3 cease operations due to frozen conditions.
4

- 5 5. Further, from the same start date, through the date of the FOIA response date of
6 August 20, 2020, there have been thirty-three (33) rain events of 0.50 inches or greater
7 according to the National Weather Service Climate Data May 2019 – August 2020
8 (Exhibit H). Unless Respondent has not provided additional reports that have been
9 completed this would be a deficit of sixty-five (65) reports.
10

11 WHEREFORE, Complainant, MICHAEL J. KORMAN, respectfully requests the Board enter an
12 order against Respondent, ILLINOIS DEPARTMENT OF TRANSPORTATION, with respect to

13 Count 3:

- 14 1. Authorizing a hearing in this matter at which time Respondent will be required to
15 answer the allegations herein;
16
17 2. Finding that Respondent has violated Sections 12(f) of the Act, 415 ILCS 5/12(f)
18 (2018), Sections 309.102(a), and 309.103 of the Board Water Pollution Regulations,
19 35 Ill. Adm. Code 309.102(a) and 309.103, and NPDES Standard Condition No. 2;
20
21 3. Ordering Respondent to cease and desist from any further violations of Section 12(f)
22 of the Act, 415 ILCS 5/12(f) (2018), Sections 309.102(a) and 309.103, and NPDES
23 Standard Condition No. 2;
24
25 4. Assessing against Respondent a civil penalty of Fifty Thousand Dollars (\$50,000.00)
26 for each of violation of Section 12(f) of the Act, 415 ILCS 5/12(f) (2018), Sections
27 309.102(a) and 309.103 of the Board Water Pollution Regulations, 35 Ill. Adm. Code
28 309.102(a) and 309.104(a), and NPDES Standard Condition No. 2, and an additional

1 civil penalty of Ten Thousand Dollars (\$10,000.00) for each missed inspection; or a
2 total of Seven-hundred Thousand Dollars (\$700,000.000).

- 3
4 5. Requiring Respondent to file an Incident of Noncompliance as it relates to Count 3 as
5 required as part of the NPDES Permit program for this project.
6
6. Granting such other relief as the Board deems appropriate and just.

7 **COUNT 4**

8 Improper Noticing of Project as follows:

- 9
10 1. Respondent failed to place a Public Notice IAW 35 Ill. Adm. Code 302.102(a)(2).
11
12 2. IAW NPDES Permit # ILR10AV06 Part II. Notice of Intent Requirements Part E
13 Additional Notification Respondent 'shall also submit signed copies of the Notice of
14 Intent to the local agency approving such plans approving such plans.
15
16 a. Complainant filed a FOIA request to the Village of Glenview on 14
17 September 2020 seeking copies of the Notice of Intent that was required to
18 be filed by Respondent to the Village of Glenview. On 21 September 2020
19 Complainant received a response from the Village of Glenview indicating
20 that no such notice is available at the Village of Glenview. (Exhibit I)

21 WHEREFORE, Complainant, MICHAEL J. KORMAN, respectfully requests the Board enter an
22 order against Respondent, ILLINOIS DEPARTMENT OF TRANSPORTATION, with respect to

23 Count 4:

- 24 1. Authorizing a hearing in this matter at which time Respondent will be required to
25 answer the allegations herein;
26
27
28

- 1 2. Finding that Respondent has violated Sections 12(f) of the Act, 415 ILCS 5/12(f)
2 (2018), Sections 309.102(a), and 309.103 of the Board Water Pollution Regulations,
3 35 Ill. Adm. Code 309.102(a) and 309.103, and NPDES Standard Condition No. 2;
4
- 5 3. Ordering Respondent to cease and desist from any further violations of Section 12(f)
6 of the Act, 415 ILCS 5/12(f) (2018), Sections 309.102(a) and 309.103, and NPDES
7 Standard Condition No. 2;
- 8 4. Assessing against Respondent a civil penalty of Fifty Thousand Dollars (\$50,000.00)
9 for each of violation of Section 12(f) of the Act, 415 ILCS 5/12(f) (2018), Sections
10 309.102(a) and 309.103 of the Board Water Pollution Regulations, 35 Ill. Adm. Code
11 309.102(a) and 309.104(a), and NPDES Standard Condition No. 2, or a total of One-
12 hundred Thousand Dollars (\$100,000.000).
13
- 14 5. Requiring Respondent to file an Incident of Noncompliance as it relates to Count 4 as
15 required as part of the NPDES Permit program for this project.
- 16 6. Requiring Respondent to become compliant with these notices.
- 17 7. Granting such other relief as the Board deems appropriate and just.
18
19
20
21
22
23
24
25
26
27
28

COUNT 5

1
2 Complainant has documented photographic evidence of the ongoing and malfeasant stormwater
3 pollution occurring at this project under NPDES Permit # ILR10AV06:
4

- 5 1. Complainant alleges the following specific types of pollution at this project site: When
6 it rains, stormwater washes over the loose soil on the construction site, along with
7 various materials and products being stored outside. As stormwater flows over the site
8 it picks up pollutants like sediment, debris, and chemicals from that loose soil and
9 transports them to nearby storm sewer systems or directly into rivers and lakes.
10 Specifically, pollution is travelling from the upper roadway of Willow Road to the
11 stormwater conveyance systems to the North and South of the Roadway to the MS4
12 systems operated by the Villages of Glenview and Northbrook which feed the
13 downstream watersheds to the South of the project including the Kent Fuller Air
14 Station Prairie Preserve and Lake Glenview as well as to the West Fork of the North
15 Branch of the Chicago River. Stormwater pollution also drops to the Village of
16 Glenview maintained roadway, Patriot Boulevard, which is located under the active
17 Willow Road construction project where stormwater and pollution travels to the storm
18 inlets and over the roadway which continue to the Kent Fuller Air Station Prairie
19 Preserve and Lake Glenview. Pollutants include:
20
21

- 22 a. Soil, sediments, sand and minerals used in construction
23 b. Concrete waste and washouts from cement trucks
24 c. POL including: Fuel (Diesel & Gasoline), Motor Oil, grease, antifreezes,
25 brake fluid, battery fluids, solvents
26 d. Paints
27 e. Trash & debris
28 f. Nutrients (Phosphorus, Nitrogen, etc.), Pesticides

- 1 g. Metals including Aluminum, Copper, Iron and Lead
- 2 h. Chemical Oxygen Demand (COD) & Biochemical Oxygen Demand (BOD)
- 3 i. Bacteria, viruses and other pathogens

- 4 2. The many Stormwater Inlets on Willow Road and Patriot Road are outfalls associated
5 with the Stormwater Pollution at the Facility is a “point source” within the meaning of
6 40 C.F.R. 401.11(d).
- 7 3. Complainant is prepared to provide photographic evidence, both aerial and terrestrial,
8 should the Board request a hearing on this count.

9 WHEREFORE, Complainant, MICHAEL J. KORMAN, respectfully requests the Board enter an
10 order against Respondent, ILLINOIS DEPARTMENT OF TRANSPORTATION, with respect to

11 Count 5:

- 12 1. Authorizing a hearing in this matter at which time Respondent will be required to
13 answer the allegations herein;
- 14 2. Finding that Respondent has violated Sections 12(a) and 12(f) of the Act, 415 ILCS
15 5/12(a) and 12(f) (2018), Sections 309.102(a), and 309.103 of the Board Water
16 Pollution Regulations, 35 Ill. Adm. Code 309.102(a) and 309.103, and NPDES
17 Standard Condition No. 2;
- 18 3. Ordering Respondent to cease and desist from any further violations of Section 12(a)
19 and 12(f) of the Act, 415 ILCS 5/12(a) and 12(f) (2018), Sections 309.102(a) and
20 309.103, and NPDES Standard Condition No. 2;
- 21 4. Order Respondent to take pollution abatement measures, to clean up contamination
22 and to partner with the Village of Glenview, at no cost to the Village, to clean and
23 repair any damaged parts of the MS4 system.
- 24 5. In accordance with 415 ILCS 5/42 (h)(8) the ‘penalty is at least as great as the
25 economic benefits of the violation’. In Complainant’s view, the economic benefit
26 derived is the dollar difference in the cost of being fully compliant with the NPDES
27 Permit herein from day one of project through completion less the cost of installed
28 NPDES mitigation best management practices of the project.
6. In addition, assessing against Respondent a civil penalty of Fifty Thousand Dollars
(\$50,000.00) for each of violation of Section 12(f) of the Act, 415 ILCS 5/12(f)

1 (2018), Sections 309.102(a) and 309.103 of the Board Water Pollution Regulations,
2 35 Ill. Adm. Code 309.102(a) and 309.104(a), and NPDES Standard Condition No. 2.
3 7. Granting such other relief as the Board deems appropriate and just.

4 **Dated September 22, 2020**

5 
6 **Complainant's Name**

8
9 SUBSCRIBED AND SWORN BEFORE ME
10 THIS 23rd DAY OF SEPTEMBER 2020

11 
12 NOTARY PUBLIC

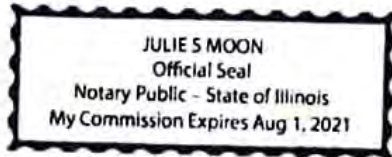

Electronic Filing: Received, Clerk's Office 09/24/2020

*use browser print option to print

Contact Information

Owner Name: Illinois Department of Transportation

Mailing Address: 201 W Center Court

City: Schaumburg

State: IL

Zip: 60196

Contact Person: Giovanna Zaffina

Owner Type: State

Area Code: 847

Phone #: 705-4172

Extension:

Contractor Name: LORIG CONSTRUCTION COMPANY

Area Code: 847

Phone #: 298-0360

Ext.:

Mailing Address: 250 East Touhy Ave

City: Des Plaines

State: IL

Zip: 60018

Location of SWPPP: Site/Field Office

Location City: Glenview

Contact First Name: James

Contact Last Name: Stewart

Contact Phone #: 847-705-4003-

Contact FAX #: --

Contact Inspector Qualifications: OTHER

Other Description:

Inspector First Name:

Inspector Last Name:

Inspector Phone #: --

Inspector FAX #: --

Inspector Qualifications: NONE

Other Description: RE will assign inspector

Site/Compliance/Misc. Information

Facility Name: IDOT Contract 60N83. Mar '19 Letting Item 4. SN-016-0533 Carrying Willow Rd

Facility Location: Willow Road over Lehigh and SOO line

City: Glenview

State: IL

Zip: 60026

Latitude Degrees: 42.105556

Longitude Degrees: -87.814417

County: COOK

Section: 22

Township: 42N

Range: 12E

Construction Type: Transportation

SIC:

Constr. Start Date: 05/19/2019

Constr. End Date: 12/19/2020

Project Brief Description: Rehabilitation and widening on SN 016-0533 carrying Willow Road over Lehigh and SOO line in Glenview.

Historic Preservation: Yes

Endangered Species: Yes

Impaired Water:

Discharge Type: Waters of the State

Storm Sewer Owner: IDOT, Cook County, Village of

Closest Receiving Water: West fork of the North Branch

NPDES Permit Number: ILR10AV06

Permit Id: 37006

Received Date: 05/14/2019 **B**

NOI Submitted Date: 05/08/2019 **A**

Approved Date:

Permit Issue Date:

Permit Coverage Date: 06/18/2019 **C**

Termination Date:

Stabilization Date:

Expiration Date: 07/31/2023

Modification Date:

Main IDOT Project Site

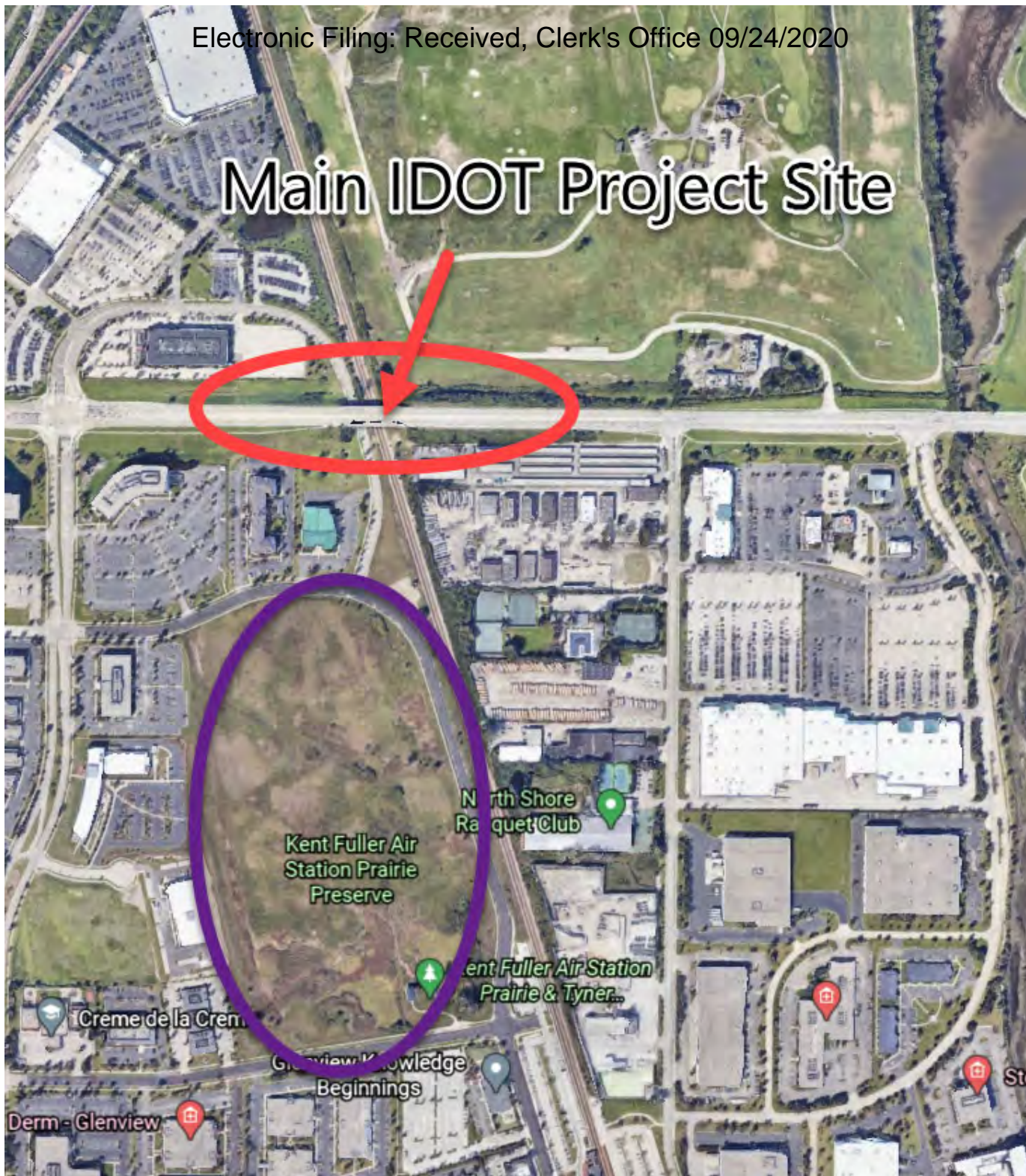

Project Site

**West Fork of the North Branch
of the Chicago River**

**Techny
Basin**

Flow

North

Complainant's Residence

Lake Glenview



FOIA REQUEST

FOIA Officer
Illinois Department of Transportation
Office of the Chief Counsel, Room 313
2300 South Dirksen Parkway
Springfield, Illinois 62764

Name and Address of Public Body Receiving Request: _____

Date Requested: August 20, 2020

Request Submitted By: E-mail U.S. Mail Fax In Person

Name of Requester: Michael J. Korman

Street Address: 2306 Sundrop Drive

City/State/County Zip (required): Glenview, Illinois 60026

Telephone (Optional): 847-800-4782 E-mail (Optional): mike.korman@kormanllc.com

Fax (Optional): 847-728-8046

Records Requested: **Provide as much specific detail as possible so the public body can identify the information that you are seeking. You may attach additional pages, if necessary.*

IDOT Contract 60N83. Mar '19 Letting Item 4. SN-016-0533 Carrying Willow Rd

In accordance with IEPA ILR10 NPDES Permit # ILR10AV06 Part IV B.6 I am seeking the following:

All Stormwater Pollution Protection Plans and all completed inspection forms/reports for duration

Do you want copies of the documents? YES or NO

--Do you want Electronic Copies or Paper Copies? Electronic

--If you want Electronic Copies, in what format? PDF by Email

Is this request for a Commercial Purpose? YES or NO

(It is a violation of the Freedom of Information Act for a person to knowingly obtain a public record for a commercial purpose without disclosing that it is for a commercial purpose, if requested to do so by the public body. 5 ILCS 140.3.1(c)).

Are you requesting a fee waiver? YES or NO

(If you are requesting that the public body waive any fees for copying the documents, you must attach a statement of the purpose of the request, and whether the principal purpose of the request is to access or disseminate information regarding the health, safety and welfare or legal rights of the general public. 5 ILCS 140/6(c)).



**Illinois Department
of Transportation**

Weekly Report

Contractor: Lorig Construction Company
 Contract Completion Date: 10/30/2020
 Contract Working Days: 0
 Resident Name: Glen Pennington

Week Ending 5/25/2019
 Contract Price: \$9,419,423.88
 Route: FAP 305 Willow Rd.
 District: 1
 Contract No.: 60N83

Weather

Date	Weather	Temp. (F)	Precip. (inches)	Wind	Weather Comments
Sun 5/19/2019	44 to 76 degrees; rain				
Mon 5/20/2019	47 to 58 degrees				
Tue 5/21/2019	43 to 56 degrees; rain				
Wed 5/22/2019	52 to 80 degrees; rain				
Thu 5/23/2019	64 to 75 degrees; rain				
Fri 5/24/2019	54 to 72 degrees; drizzle				
Sat 5/25/2019	72 to 82 degrees				



**Illinois Department
of Transportation**

Weekly Report

Contractor: Lorig Construction Company
 Contract Completion Date: 10/30/2020
 Contract Working Days: 0
 Resident Name: Glen Pennington

Week Ending 5/25/2019
 Contract Price: \$9,419,423.88
 Route: FAP 305 Willow Rd.
 District: 1
 Contract No.: 60N83

Controlling Item

Date	Controlling Item	Working Day Charge	Workable Day	Controlling Item Comment
Sun 5/19/2019	Public Information Period	0.00	0.00	No Work; Rain
Mon 5/20/2019	Median Removal	0.00	1.00	Work Zone Safety installed temporary pavement markings & delivered Type II Barrels along Willow Road from just east of Patriot Blvd & west of Old Willow Rd.
Tue 5/21/2019	Median Removal	0.00	0.00	Lorig started sawcutting along Willow Road for Pre-Stage 1 CC&G & Median Removal from Sta. 92+50 To 98+50 and Sta. 107+20 to Sta 101+50. Lorig submitted RFI 12. No Working charged due to rain.
Wed 5/22/2019	Median Removal	0.00	0.00	Lorig continued sawcutting along Willow Road for Pre-Stage 1 CC&G & Median Removal from Sta. 92+50 To 98+50 and Sta. 107+20 to Sta 101+50. Lorig CC submitted RFI 13.No Working charged due to rain.
Thu 5/23/2019	Median Removal	0.00	0.00	Lorig started removing the existing concrete median along Willow Road from Sta. 107+20 to Sta 101+50. No Working charged due to rain.
Fri 5/24/2019	Median Removal	0.00	0.50	Lorig continued removing the existing concrete median and CC&G along Willow Road from Sta. 107+20 to Sta 101+50 and Sta 92+50 to Sta 98+50. Lorig CC submitted approval for the drilled shaft equipment and method.
Sat 5/25/2019	Median Removal	0.00	1.00	No Work

Electronic Filing: Received, Clerk's Office 09/24/2020

Contractor: Lorig Construction Company
Contract Completion Date: 10/30/2020
Contract Working Days: 0
Resident Name: Glen Pennington

Week Ending 5/25/2019
Contract Price: \$9,419,423.88
Route: FAP 305 Willow Rd.
District: 1
Contract No.: 60N83

Prime / Subcontractor's Summary

Date	Contractor Name	Hours Worked	Person(s) Working	Work Activity Summary
Sun 5/19/2019	Lorig Construction Company	0.00	0	
Mon 5/20/2019	Lorig Construction Company	6.00	2	
Tue 5/21/2019	Lorig Construction Company	8.00	3	
Wed 5/22/2019	Lorig Construction Company	8.00	3	
Thu 5/23/2019	Lorig Construction Company	8.00	3	
Fri 5/24/2019	Lorig Construction Company	9.00	3	
Sat 5/25/2019	Lorig Construction Company	0.00	0	



State of Illinois
JB Pritzker, Governor



Illinois Department of Transportation
Omer Osman, Acting Secretary

FOR IMMEDIATE RELEASE:
May 22, 2019

CONTACT:
Guy Tridgell 312.793.4199

Bridge deck replacement on Willow Road in Glenview

CHICAGO – The Illinois Department of Transportation announced that repairs to the bridge carrying Willow Road over the Metra Milwaukee District Line tracks between Patriot Boulevard and Old Willow Road, in Glenview, will begin this week.

While construction is ongoing, two lanes of traffic will remain open in both directions, though intermittent closures during non-peak hours should be anticipated initially while the work zone is established. Changes to traffic flow will be denoted by temporary barrier walls and pavement markings. Businesses in the work zone will have continuous access to Willow Road during the project.

The work is expected to be complete by October 2020.

Motorists can expect delays and should allow extra time for trips through this area. Drivers are urged to pay close attention to flaggers and signs in the work zones, obey the posted speed limits and be on the alert for workers and equipment.

Click [here](#) to find details on other construction projects in IDOT's District 1. Updates on the impacts to traffic are available at www.travelmidwest.com.

###



ILLINOIS ENVIRONMENTAL PROTECTION AGENCY

1021 NORTH GRAND AVENUE EAST, P.O. BOX 19276, SPRINGFIELD, ILLINOIS 62794-9276 • (217) 782-2829

217782-0610

6/18/2019

Illinois Department of Transportation
Giovanna Zaffina
201 W Center Court
Schaumburg, IL 60196

RE: FACILITY : IDOT Contract 60N83. Mar '19 Letting Item 4. SN-016-0533 Carrying Willow Rd, Glenview, IL
COUNTY : COOK, NPDES Permit No : ILR10AV06
Notice of Coverage Under Construction Site Activity Storm Water General Permit

Dear NPDES Permittee:

We have reviewed your application and determined that storm water discharges associated with industrial activity from construction sites are appropriately covered by the attached General NPDES Permit issued by the Agency. Your discharge is covered by this permit effective as of the date of this letter or as identified by the conditions of the permit. The Permit as issued covers application requirements, a storm water pollution prevention plan and reporting requirements.

As a Permit Holder, it is your responsibility to:

1. Submit a modified Notice of Intent of any **ownership or address change** to the Permit Section within 30 days;
2. **A Notice of Termination** must be sent to the Agency, at the address indicated on the Notice of Termination, once your construction project has been **completed and the site is properly stabilized**. A Notice of Termination form has been enclosed for your convenience;

This letter shows your facility permit number below the construction site name. Please save this number and reference it in all future correspondence. Should you have any questions concerning the Permit, please contact Melissa Parrott at (217) 782-0610.

Very truly yours,

Amy L. Dragovich, P.E.
Manager, Permit Section
Division of Water Pollution Control

EPA - DIVISION OF RECORDS MANAGEMENT
RELEASABLE

SEP 16 2020

REVIEWER KAJ

IPCB Case # 2020-062 Korman v IDOT (1 of 7 pages)

CC : **Records Unit**, North Cook County SWCD, Will - South Cook County SWCD, Region : DesPlaines

4302 N. Main St., Rockford, IL 61103 (815)967-7760
595 S. State, Elgin, IL 60123 (847)608-3131
2125 S. First St., Champaign, IL 61820 (217)278-5800
2009 Mall St., Collinsville, IL 62234 (618)346-5120

9511 Harrison St., Des Plaines, IL 60016 (847)294-4000
5407 N. University St., Arber 113, Peoria, IL 61614 (309)693-5462
2309 W. Main St., Suite 116, Marion, IL 62959 (618)993-7200
100 W. Randolph, Suite 11-300, Chicago, IL 60601 (312)814-6026

Electronic Filing: Received, Clerk's Office 09/24/2020

[Back To Permit Maintenance](#) *use browser print option to print

Contact Information

Owner Name: **Illinois Department of Transportation**

Mailing Address: **201 W Center Court**

City: **Schaumburg**

State: **IL**

Zip: **60196**

Contact Person: **Giovanna Zaffina**

Owner Type: **State**

Area Code: **847**

Phone #: **705-4172**

Extension:

MS4 Community: **Yes**

Contractor Name: **LORIG CONSTRUCTION COMPANY**

Area Code: **847**

Phone #: **298-0360**

Ext.:

Mailing Address: **250 East Touhy Ave**

City: **Des Plaines**

State: **IL**

Zip: **60018**

Location of SWPPP: **Site/Field Office**

Location City: **Glenview**

Contact First Name: **James**

Contact Last Name: **Stewart**

Contact Phone #: **847-705-4003-**

Contact FAX #: **--**

Contact Inspector Qualifications: **OTHER**

Other Description:

Inspector First Name:

Inspector Last Name:

Inspector Phone #: **--**

Inspector FAX #: **--**

Inspector Qualifications: **NONE**

Other Description: **RE will assign inspector**

Site/Compliance/Misc. Information

Facility Name: **IDOT Contract 60N83. Mar '19 Letting Item 4. SN-016-0533 Carrying Willow Rd**

Facility Location: **Willow Road over Lehigh and SOO line**

City: **Glenview**

State: **IL**

Zip: **60026**

Latitude Degrees: **42.105556**

Longitude Degrees: **-87.814417**

County: **COOK**

Section: **22**

Township: **42N**

Range: **12E**

Construction Type: **Transportation**

SIC:

Constr. Start Date: **05/19/2019**

Constr. End Date: **12/19/2020**

Site Size(In Acres): **3.5000**

If less than 1 acre, is the site part of a larger common plan of development? **Yes**

Project Brief Description: **Rehabilitation and widening on SN 016-0533 carrying Willow Road over Lehigh and SOO line in Glenview.**

Historic Preservation: **Yes**

Endangered Species: **Yes**

Impaired Water:

Discharge Type: **Waters of the State**

Storm Sewer Owner: **IDOT, Cook County, Village of G**

Closest Receiving Water: **West fork of the North Branch of Chicago River**

NPDES Permit Number: **ILR10AV06**

Permit Id: **37006**

Received Date: **05/14/2019**

Approved Date:

Permit Issue Date:

Permit Coverage Date:

Termination Date:

Stabilization Date:

Expiration Date:

Modification:

Submittal Date:

IEPA - DIVISION OF RECORDS MANAGEMENT
RELEASABLE

SEP 16 2020

REVIEWER KAJ

Electronic Filing: Received, Clerk's Office 09/24/2020

I certify under penalty of law that information and files uploaded to this website were prepared under my direction and supervision in accordance with a system designed to assure that qualified personnel properly gather and evaluate the information submitted. Based on my inquiry of the person or person(s) who manage this system, or those persons directly responsible for gathering the information, the information submitted is, to the best of my knowledge and belief, true, accurate, and complete. I am aware that there are significant penalties for submitting false information, including the possibility of fine and imprisonment. In addition, I certify that the provisions of the permit, including the development and implementation of a storm water pollution prevention plan and a monitoring program plan, will be complied with. I also certify that, to the best of my knowledge, the storm water which is discharged from this facility\site does not contain process wastewater, domestic wastewater, domestic wastewater, or cooling water.

Any person who knowingly makes a false, fictitious, or fraudulent material statement, orally, via information submitted from this website, or in writing, to the Illinois EPA commits a class 4 felony. A second or subsequent offense after conviction is a class 3 felony. (415 ILCS 5/44(h))

Submitted By:

Registered User Name:

Richard Robert Wanner

Title:

Erosion and Sediment Control Coordi

Id:

rick.wanner@illinois.gov

NOI Submitted Date:

05/08/2019

Submitted For The Following Permit Owner:

Owner Name:

Illinois Department of Transportatio

I accept these terms and conditions

[Back To Permit Maintenance](#) *use browser print option to print

Contact Information

Owner Name:	Illinois Department of Transportation
Mailing Address:	201 W Center Court
City:	Schaumburg
State:	IL
Zip:	60196
Contact Person:	Giovanna Zaffina
Owner Type:	State
Area Code:	847
Phone #:	705-4172
Extension:	
MS4 Community:	<input checked="" type="checkbox"/> Yes
Contractor Name:	LORIG CONSTRUCTION COMPANY
Area Code:	847
Phone #:	298-0360
Ext.:	
Mailing Address:	250 East Touhy Ave
City:	Des Plaines
State:	IL
Zip:	60018
Location of SWPPP:	Site/Field Office
Location City:	Glenview
Contact First Name:	James
Contact Last Name:	Stewart
Contact Phone #:	847-705-4003-
Contact FAX #:	--
Contact Inspector Qualifications:	OTHER
Other Description:	
Inspector First Name:	
Inspector Last Name:	
Inspector Phone #:	--
Inspector FAX #:	--
Inspector Qualifications:	NONE
Other Description:	RE will assign inspector

Site/Compliance/Misc. Information

Facility Name:	IDOT Contract 60N83, Mar '19 Letting Item 4. SN-016-0533 Carrying Willow Rd
Facility Location:	Willow Road over Lehigh and 500 line
City:	Glenview
State:	IL
Zip:	60026
Latitude Degrees:	42.105556
Longitude Degrees:	-87.814417
County:	COOK
Section:	22
Township:	42N
Range:	12E
Construction Type:	Transportation
SIC:	
Constr. Start Date:	05/19/2019
Constr. End Date:	12/19/2020
Site Size(In Acres):	3.5000
If less than 1 acre, is the site part of a larger common plan of development?	<input type="checkbox"/> Yes
Project Brief Description:	Rehabilitation and widening on SN 016-0533 carrying Willow Road over Lehigh and 500 line in Glenview.
Historic Preservation:	Yes
Endangered Species:	Yes
Impaired Water:	
Discharge Type:	Waters of the State
Storm Sewer Owner:	IDOT, Cook County, Village of G
Closest Receiving Water:	West fork of the North Branch of
NPDES Permit Number:	ILR10AV06
Permit Id:	37006
Received Date:	05/14/2019
Approved Date:	
Permit Issue Date:	
Permit Coverage Date:	06/18/2019
Termination Date:	
Stabilization Date:	
Expiration Date:	07/31/2023
Modification Submittal Date:	

REPA - DIVISION OF RECORDS MANAGEMENT
 RELEASEABLE
 SEP 16 2020
 REVIEWER KAJ

I certify under penalty of law that information and files uploaded to this website were prepared under my direction and supervision in accordance with a system designed to assure that qualified personnel properly gather and evaluate the information submitted. Based on my inquiry of the person or person(s) who manage this system, or those persons directly responsible for gathering the information, the information submitted is, to the best of my knowledge and belief, true, accurate, and complete. I am aware that there are significant penalties for submitting false information, including the possibility of fine and imprisonment. In addition, I certify that the provisions of the permit, including the development and implementation of a storm water pollution prevention plan and a monitoring program plan, will be complied with. I also certify that, to the best of my knowledge, the storm water which is discharged from this facility/site does not contain process wastewater, domestic wastewater, domestic wastewater, or cooling water.

Any person who knowingly makes a false, fictitious, or fraudulent material statement, orally, via information submitted from this website, or in writing, to the Illinois EPA commits a class 4 felony. A second or subsequent offense after conviction is a class 3 felony. (415 ILCS 5/44(h))

Submitted By:

Registered User Name:

Richard Robert Wanner

Title:

Erosion and Sediment Control Coordi

Id:

rick.wanner@illinois.gov

NOI Submitted Date:

05/08/2019

Submitted For The Following Permit Owner:

Owner Name:

Illinois Department of Transportatio

I accept these terms and conditions

**ELECTRONIC SUBMITTAL GENERAL PERMIT TO
DISCHARGE STORM WATER FROM CONSTRUCTION
ACTIVITIES**

REVIEW NOTES

ILR10 AVOL

NOI SUBMITTAL DATE 5 / 8 / 19

NOI LOG IN DATE 5 / 14 / 19

FEE RECEIVED 750 250 CHECK # _____

EXEMPT

MS4 SCHOOL STATE FEDERAL

ACREAGE 3.5

SWPPP RECEIVED Q

HPA Q 5/14

DNR Q

IEPA - DIVISION OF RECORDS MANAGEMENT
RELEASABLE
SEP 16 2020
REVIEWER KAJ

Back To Permit Maintenance *use browser print option to print

Contact Information

Owner Name: **Illinois Department of Transportation**

Mailing Address: **201 W Center Court**

City: **Schaumburg**

State: **IL**

Zip: **60196**

Contact Person: **Giovanna Zaffina**

Owner Type: **State**

Area Code: **847**

Phone #: **705-4172**

Extension:

MS4 Community: Yes

Contractor Name: **LORIG CONSTRUCTION COMPANY**

Area Code: **847**

Phone #: **298-0360**

Ext:

Mailing Address: **250 East Touhy Ave**

City: **Des Plaines**

State: **IL**

Zip: **60018**

Location of SWPPP: **Site/Field Office**

Location City: **Glenview**

Contact First Name: **James**

Contact Last Name: **Stewart**

Contact Phone #: **847-705-4003-**

Contact FAX #: **--**

Contact Inspector Qualifications: **OTHER**

Other Description:

Inspector First Name:

Inspector Last Name:

Inspector Phone #: **--**

Inspector FAX #: **--**

Inspector: **NONE**

Qualifications:

Other Description: **RE will assign inspector**

Site/Compliance/Misc. Information

Facility Name: **IDOT Contract 60N83. Mar '19 Letting Item 4. SN-016-0533 Carrying Willow Rd**

Facility Location: **Willow Road over Lehigh and SOO line**

City: **Glenview**

State: **IL**

Zip: **60026**

Latitude Degrees: **42.105556**

Longitude Degrees: **-87.814417**

County: **COOK**

Section: **22**

Township: **42N**

Range: **12E**

Construction Type: **Transportation**

SIC:

Constr. Start Date: **05/19/2019**

Constr. End Date: **12/19/2020**

Site Size(In Acres): **3.5000**

If less than 1 acre, is the site part of a larger common plan of development? Yes

Project Brief Description: **Rehabilitation and widening on SN 016-0533 carrying Willow Road over Lehigh and SOO line in Glenview.**

Historic Preservation: **Yes**

Endangered Species: **Yes**

Impaired Water:

Discharge Type: **Waters of the State**

Storm Sewer Owner: **IDOT, Cook County, Village of G**

Closest Receiving Water: **West fork of the North Branch r**

NPDES Permit Number: **ILR10AV06**

Permit Id: **37006**

Received Date: **05/14/2019**

Approved Date:

Permit Issue Date:

Permit Coverage Date:

Termination Date:

Stabilization Date:

Expiration Date:

Modification:

Submittal Date:

RECEIVED
MAY 21 2019
PRESERVATION SERVICES

IHPA REVIEW
H/A
AC MPA JOR 5/23/19
AR
File

IEPA - DIVISION OF RECORDS MANAGEMENT
RELEASABLE
SEP 16 2020
REVIEWER KAJ

Explanation of the Preliminary Monthly Climate Data (F6) Product

These data are preliminary and have not undergone final quality control by the National Climatic Data Center (NCDC). Therefore, these data are subject to revision. Final and certified climate data can be accessed at the NCDC - <http://www.ncdc.noaa.gov>.

WFO Monthly/Daily Climate Data

000
 CXUS55 KLOT 010700
 CF60RD
 PRELIMINARY LOCAL CLIMATOLOGICAL DATA (WS FORM: F-6)

STATION: CHICAGO-OHARE
 MONTH: MAY
 YEAR: 2019
 LATITUDE: 41 58 N
 LONGITUDE: 87 54 W

TEMPERATURE IN F:		:PCPN:		SNOW:		WIND		:SUNSHINE:		SKY		:PK WND						
1	2	3	4	5	6A	6B	7	8	9	10	11	12	13	14	15	16	17	18
=====																		
12Z AVG MX 2MIN																		
DY	MAX	MIN	AVG	DEP	HDD	CDD	WTR	SNW	DPTH	SPD	SPD	DIR	MIN	PSBL	S-S	WX	SPD	DR
=====																		
1	58	43	51	-3	14	0	0.80	0.0	0	8.3	21	240	M	M	10	1	33	260
2	47	41	44	-11	21	0	0.61	0.0	0	10.2	17	40	M	M	10	12	21	30
3	55	40	48	-7	17	0	0.01	0.0	0	11.1	20	30	M	M	8	1	29	20
4	63	38	51	-5	14	0	0.00	0.0	0	5.3	13	40	M	M	3		18	60
5	73	46	60	4	5	0	0.00	0.0	0	6.4	23	360	M	M	3		33	330
6	70	45	58	2	7	0	0.05	0.0	0	10.1	25	30	M	M	8		29	20
7	50	43	47	-9	18	0	0.42	0.0	0	14.5	22	40	M	M	10	1	29	40
8	68	46	57	0	8	0	0.32	0.0	0	12.1	20	70	M	M	10	1	28	70
9	67	46	57	0	8	0	0.79	0.0	0	11.5	25	250	M	M	10	1	32	250
10	58	44	51	-6	14	0	0.00	0.0	0	8.6	16	320	M	M	6		23	300
11	53	44	49	-9	16	0	0.12	0.0	0	8.6	15	60	M	M	10		21	70
12	52	42	47	-11	18	0	0.05	0.0	0	11.3	18	40	M	M	9		25	40
13	61	42	52	-6	13	0	0.00	0.0	0	7.3	15	30	M	M	4		21	350
14	71	41	56	-3	9	0	0.00	0.0	0	4.7	15	110	M	M	4		20	120
15	75	50	63	4	2	0	0.00	0.0	0	5.2	13	230	M	M	5		17	250
16	77	60	69	10	0	4	0.44	T	0	9.6	26	240	M	M	9	135	36	240
17	68	45	57	-2	8	0	0.06	0.0	0	12.3	25	20	M	M	9	3	32	20
18	80	44	62	2	3	0	0.41	0.0	0	7.5	20	130	M	M	8	13	25	120
19	74	47	61	1	4	0	0.07	0.0	0	14.6	29	250	M	M	8	13	43	240
20	57	45	51	-9	14	0	T	0.0	0	10.5	21	300	M	M	9		28	290
21	54	45	50	-11	15	0	0.33	0.0	0	15.0	28	110	M	M	10	13	40	110
22	82	49	66	5	0	1	0.59	0.0	0	14.7	30	110	M	M	8	13	41	100
23	74	61	68	7	0	3	0.08	0.0	0	11.3	24	260	M	M	3	13	34	260
24	75	54	65	3	0	0	0.26	0.0	0	7.7	18	340	M	M	9	13	23	100
25	81	70	76	14	0	11	0.00	0.0	0	11.6	24	260	M	M	6		39	240
26	74	54	64	2	1	0	T	0.0	0	5.9	15	30	M	M	7		19	30
27	73	53	63	1	2	0	1.92	0.0	0	7.7	29	120	M	M	8	13	36	100
28	70	52	61	-2	4	0	0.63	0.0	0	9.4	38	10	M	M	9	13	45	10
29	75	52	64	1	1	0	0.07	0.0	0	6.4	23	340	M	M	9	1	32	340
30	78	60	69	5	0	4	0.22	0.0	0	6.8	17	300	M	M	7	13	23	300
31	81	60	71	7	0	6	0.00	0.0	0	9.4	20	230	M	M	6		26	250
=====																		
SM	2094	1502			236	29	8.25	T		295.6			M		235			
=====																		
AV	67.6	48.5								9.5	FASTST		M	M	8		MAX(MPH)	

Electronic Filing: Received, Clerk's Office 09/24/2020

MISC: ---> # 38 '10 # 45 '10

NOTES:

LAST OF SEVERAL OCCURRENCES

COLUMN 17 PEAK WIND IN M.P.H.

PRELIMINARY LOCAL CLIMATOLOGICAL DATA (WS FORM: F-6) , PAGE 2

STATION: CHICAGO-OHARE
MONTH: MAY
YEAR: 2019
LATITUDE: 41 58 N
LONGITUDE: 87 54 W

[TEMPERATURE DATA] [PRECIPITATION DATA] SYMBOLS USED IN COLUMN 16
AVERAGE MONTHLY: 58.0 TOTAL FOR MONTH: 8.25 1 = FOG OR MIST
DPTR FM NORMAL: -1.1 DPTR FM NORMAL: 4.57 2 = FOG REDUCING VISIBILITY
HIGHEST: 82 ON 22 GRTST 24HR 1.92 ON 27-27 TO 1/4 MILE OR LESS
LOWEST: 38 ON 4 3 = THUNDER
SNOW, ICE PELLETS, HAIL 4 = ICE PELLETS
TOTAL MONTH: T 5 = HAIL
GRTST 24HR T ON 16-16 6 = FREEZING RAIN OR DRIZZLE
GRTST DEPTH: 0 7 = DUSTSTORM OR SANDSTORM:
VSBY 1/2 MILE OR LESS
8 = SMOKE OR HAZE
9 = BLOWING SNOW
X = TORNADO
[NO. OF DAYS WITH] [WEATHER - DAYS WITH]
MAX 32 OR BELOW: 0 0.01 INCH OR MORE: 21
MAX 90 OR ABOVE: 0 0.10 INCH OR MORE: 14
MIN 32 OR BELOW: 0 0.50 INCH OR MORE: 6
MIN 0 OR BELOW: 0 1.00 INCH OR MORE: 1

[HDD (BASE 65)]
TOTAL THIS MO. 236 CLEAR (SCALE 0-3) 1
DPTR FM NORMAL 11 PTCLDY (SCALE 4-7) 14
TOTAL FM JUL 1 6425 CLOUDY (SCALE 8-10) 16
DPTR FM NORMAL 133

[CDD (BASE 65)]
TOTAL THIS MO. 29
DPTR FM NORMAL -15 [PRESSURE DATA]
TOTAL FM JAN 1 33 HIGHEST SLP M ON M
DPTR FM NORMAL -21 LOWEST SLP 29.55 ON 19

[REMARKS]
#FINAL-05-19#

Explanation of the Preliminary Monthly Climate Data (F6) Product

These data are preliminary and have not undergone final quality control by the National Climatic Data Center (NCDC). Therefore, these data are subject to revision. Final and certified climate data can be accessed at the NCDC - <http://www.ncdc.noaa.gov>.

WFO Monthly/Daily Climate Data

516
 CXUS55 KLOT 010700
 CF60RD
 PRELIMINARY LOCAL CLIMATOLOGICAL DATA (WS FORM: F-6)

STATION: CHICAGO-OHARE
 MONTH: JUNE
 YEAR: 2019
 LATITUDE: 41 58 N
 LONGITUDE: 87 54 W

TEMPERATURE IN F:		:PCPN:		SNOW:		WIND		:SUNSHINE:		SKY		:PK WND						
1	2	3	4	5	6A	6B	7	8	9	10	11	12	13	14	15	16	17	18
=====																		
12Z AVG MX 2MIN																		
DY	MAX	MIN	AVG	DEP	HDD	CDD	WTR	SNW	DPTH	SPD	SPD	DIR	MIN	PSBL	S-S	WX	SPD	DR
=====																		
1	80	53	67	3	0	2	T	0.0	0	8.9	25	10	M	M	9	3	39	10
2	70	51	61	-3	4	0	0.00	0.0	0	8.8	18	30	M	M	3		25	360
3	67	49	58	-7	7	0	0.00	0.0	0	8.1	13	70	M	M	7		18	30
4	82	56	69	4	0	4	0.29	0.0	0	10.4	22	200	M	M	8	13	31	230
5	83	59	71	5	0	6	0.29	0.0	0	9.3	22	40	M	M	7	13	34	290
6	75	56	66	0	0	1	0.00	0.0	0	6.9	12	40	M	M	8	18	16	30
7	78	55	67	1	0	2	0.00	0.0	0	8.9	17	40	M	M	3		25	50
8	76	57	67	1	0	2	T	0.0	0	9.2	17	60	M	M	6		25	60
9	75	63	69	2	0	4	T	0.0	0	5.8	13	60	M	M	9	1	17	60
10	74	60	67	0	0	2	0.00	0.0	0	13.6	25	310	M	M	4	1	37	310
11	82	57	70	2	0	5	0.00	0.0	0	8.3	15	180	M	M	5		21	190
12	71	52	62	-6	3	0	0.75	0.0	0	10.1	24	330	M	M	10	1	36	200
13	68	51	60	-8	5	0	0.05	0.0	0	14.1	25	320	M	M	7		35	340
14	80	52	66	-3	0	1	0.05	0.0	0	14.5	31	230	M	M	6	1	45	230
15	70	54	62	-7	3	0	0.02	0.0	0	8.3	17	210	M	M	10	1	25	210
16	60	54	57	-12	8	0	0.07	0.0	0	9.5	17	30	M	M	10	1	22	20
17	67	55	61	-9	4	0	0.00	0.0	0	7.7	12	20	M	M	10	1	17	40
18	78	54	66	-4	0	1	0.00	0.0	0	4.3	10	110	M	M	7	128	16	100
19	72	56	64	-6	1	0	0.18	0.0	0	9.3	20	360	M	M	9	18	24	10
20	71	54	63	-7	2	0	0.28	0.0	0	9.9	17	360	M	M	9	1	23	350
21	72	52	62	-9	3	0	T	0.0	0	7.2	17	40	M	M	6		22	40
22	79	58	69	-2	0	4	0.00	0.0	0	10.2	24	100	M	M	8		31	100
23	81	63	72	1	0	7	0.38	0.0	0	10.3	18	160	M	M	9	13	29	180
24	78	66	72	0	0	7	0.17	0.0	0	9.6	24	260	M	M	7	13	37	280
25	85	62	74	2	0	9	0.14	0.0	0	11.1	25	250	M	M	3	3	48	250
26	89	68	79	7	0	14	0.15	0.0	0	5.8	14	40	M	M	8	3	20	320
27	89	68	79	7	0	14	0.02	0.0	0	7.5	29	320	M	M	6	3	38	330
28	90	71	81	8	0	16	0.01	0.0	0	7.5	22	10	M	M	8	3	29	360
29	87	69	78	5	0	13	0.00	0.0	0	5.1	12	70	M	M	4		18	80
30	91	70	81	8	0	16	0.20	0.0	0	5.9	46	350	M	M	7	13	59	350
=====																		
SM	2320	1745			40	130	3.05		0.0	266.1			M		213			
=====																		
AV	77.3	58.2								8.9	FASTST		M	M	7		MAX(MPH)	
=====																		
MISC	----> # 46 350																	
=====																		
-----> # 59 350																		

NOTES:

LAST OF SEVERAL OCCURRENCES

COLUMN 17 PEAK WIND IN M.P.H.

PRELIMINARY LOCAL CLIMATOLOGICAL DATA (WS FORM: F-6) , PAGE 2

STATION: CHICAGO-OHARE
 MONTH: JUNE
 YEAR: 2019
 LATITUDE: 41 58 N
 LONGITUDE: 87 54 W

[TEMPERATURE DATA]

AVERAGE MONTHLY: 67.8
 DPTR FM NORMAL: -1.2
 HIGHEST: 91 ON 30
 LOWEST: 49 ON 3

[PRECIPITATION DATA]

TOTAL FOR MONTH: 3.05
 DPTR FM NORMAL: -0.40
 GRTST 24HR 0.75 ON 12-12
 SNOW, ICE PELLETS, HAIL
 TOTAL MONTH: 0.0 INCH
 GRTST 24HR 0.0
 GRTST DEPTH: 0

SYMBOLS USED IN COLUMN 16

1 = FOG OR MIST
 2 = FOG REDUCING VISIBILITY
 TO 1/4 MILE OR LESS
 3 = THUNDER
 4 = ICE PELLETS
 5 = HAIL
 6 = FREEZING RAIN OR DRIZZLE
 7 = DUSTSTORM OR SANDSTORM:
 VSBY 1/2 MILE OR LESS
 8 = SMOKE OR HAZE
 9 = BLOWING SNOW
 X = TORNADO

[NO. OF DAYS WITH]

MAX 32 OR BELOW: 0
 MAX 90 OR ABOVE: 2
 MIN 32 OR BELOW: 0
 MIN 0 OR BELOW: 0

[WEATHER - DAYS WITH]

0.01 INCH OR MORE: 16
 0.10 INCH OR MORE: 10
 0.50 INCH OR MORE: 1
 1.00 INCH OR MORE: 0

[HDD (BASE 65)]

TOTAL THIS MO. 40
 DPTR FM NORMAL -8
 TOTAL FM JUL 1 6465
 DPTR FM NORMAL 125

CLEAR (SCALE 0-3) 2
 PTCLDY (SCALE 4-7) 17
 CLOUDY (SCALE 8-10) 11

[CDD (BASE 65)]

TOTAL THIS MO. 130
 DPTR FM NORMAL -35
 TOTAL FM JAN 1 163
 DPTR FM NORMAL -56

[PRESSURE DATA]

HIGHEST SLP M ON M
 LOWEST SLP 29.58 ON 24

[REMARKS]

#FINAL-06-19#

Explanation of the Preliminary Monthly Climate Data (F6) Product

These data are preliminary and have not undergone final quality control by the National Climatic Data Center (NCDC). Therefore, these data are subject to revision. Final and certified climate data can be accessed at the NCDC - <http://www.ncdc.noaa.gov>.

WFO Monthly/Daily Climate Data

000
 CXUS55 KLOT 010700
 CF60RD
 PRELIMINARY LOCAL CLIMATOLOGICAL DATA (WS FORM: F-6)

STATION: CHICAGO-OHARE
 MONTH: JULY
 YEAR: 2019
 LATITUDE: 41 58 N
 LONGITUDE: 87 54 W

TEMPERATURE IN F:		:PCPN:		SNOW:		WIND		:SUNSHINE:		SKY		:PK WND						
1	2	3	4	5	6A	6B	7	8	9	10	11	12	13	14	15	16	17	18
=====																		
12Z AVG MX 2MIN																		
DY	MAX	MIN	AVG	DEP	HDD	CDD	WTR	SNW	DPTH	SPD	SPD	DIR	MIN	PSBL	S-S	WX	SPD	DR
=====																		
1	89	69	79	6	0	14	0.00	0.0	0	6.2	16	300	M	M	6		25	280
2	92	74	83	10	0	18	0.01	0.0	0	9.8	23	40	M	M	6	3	28	40
3	86	69	78	4	0	13	0.41	0.0	0	6.6	14	230	M	M	8	13	19	250
4	91	70	81	7	0	16	0.00	0.0	0	8.3	16	210	M	M	6	18	22	230
5	91	73	82	8	0	17	0.47	0.0	0	6.0	30	230	M	M	7	3	42	250
6	83	67	75	1	0	10	0.00	0.0	0	12.6	26	20	M	M	6	1	33	10
7	77	64	71	-3	0	6	0.00	0.0	0	13.8	20	10	M	M	7		25	20
8	83	60	72	-2	0	7	0.00	0.0	0	6.6	14	50	M	M	3		19	40
9	88	61	75	1	0	10	0.00	0.0	0	7.1	14	180	M	M	5		26	150
10	94	75	85	11	0	20	0.01	0.0	0	10.4	20	260	M	M	4		28	280
11	82	65	74	0	0	9	0.00	0.0	0	8.0	16	20	M	M	3		22	20
12	87	59	73	-1	0	8	0.00	0.0	0	6.0	15	220	M	M	1		20	220
13	94	72	83	9	0	18	0.00	0.0	0	9.7	18	30	M	M	5		23	240
14	91	70	81	7	0	16	T	0.0	0	6.4	15	80	M	M	4	3	21	70
15	92	74	83	9	0	18	0.00	0.0	0	11.6	25	190	M	M	3		35	180
16	82	71	77	3	0	12	0.05	0.0	0	6.4	15	170	M	M	8	1	21	160
17	92	74	83	9	0	18	0.47	0.0	0	5.4	26	190	M	M	7	138	41	180
18	87	71	79	5	0	14	1.36	0.0	0	11.0	25	200	M	M	7	13	39	200
19	93	81	87	13	0	22	0.00	0.0	0	11.8	18	210	M	M	6		26	210
20	95	73	84	10	0	19	0.08	0.0	0	11.6	32	10	M	M	7	13	41	350
21	79	67	73	-1	0	8	0.76	0.0	0	12.3	23	30	M	M	8	138	27	20
22	75	62	69	-5	0	4	0.00	0.0	0	12.8	25	30	M	M	4		35	30
23	80	62	71	-3	0	6	0.00	0.0	0	7.5	17	360	M	M	3		23	320
24	81	62	72	-2	0	7	0.00	0.0	0	5.2	13	60	M	M	1		18	60
25	85	63	74	0	0	9	0.00	0.0	0	4.9	12	170	M	M	2		16	150
26	85	67	76	2	0	11	0.00	0.0	0	9.4	17	170	M	M	7		23	200
27	89	71	80	6	0	15	0.00	0.0	0	13.6	23	230	M	M	3		34	200
28	89	73	81	7	0	16	0.00	0.0	0	11.3	21	220	M	M	5		28	210
29	82	70	76	2	0	11	0.32	0.0	0	8.1	28	330	M	M	6	13	36	310
30	78	65	72	-2	0	7	0.00	0.0	0	7.9	16	60	M	M	4		24	40
31	76	59	68	-6	0	3	0.00	0.0	0	9.0	17	30	M	M	3		29	40
=====																		
SM	2668	2113			0	382	3.94		0.0	277.3			M		155			
=====																		
AV	86.1	68.2								8.9	FASTST		M	M	5		MAX(MPH)	

Electronic Filing: Received, Clerk's Office 09/24/2020

MISC: ---> # 32 10 # 42 250

NOTES:

LAST OF SEVERAL OCCURRENCES

COLUMN 17 PEAK WIND IN M.P.H.

PRELIMINARY LOCAL CLIMATOLOGICAL DATA (WS FORM: F-6) , PAGE 2

STATION: CHICAGO-OHARE
MONTH: JULY
YEAR: 2019
LATITUDE: 41 58 N
LONGITUDE: 87 54 W

[TEMPERATURE DATA] [PRECIPITATION DATA] SYMBOLS USED IN COLUMN 16
AVERAGE MONTHLY: 77.1 TOTAL FOR MONTH: 3.94 1 = FOG OR MIST
DPTR FM NORMAL: 3.1 DPTR FM NORMAL: 0.24 2 = FOG REDUCING VISIBILITY
HIGHEST: 95 ON 20 GRTST 24HR 1.36 ON 18-18 TO 1/4 MILE OR LESS
LOWEST: 59 ON 31,12 3 = THUNDER
SNOW, ICE PELLETS, HAIL 4 = ICE PELLETS
TOTAL MONTH: 0.0 INCH 5 = HAIL
GRTST 24HR 0.0 6 = FREEZING RAIN OR DRIZZLE
GRTST DEPTH: 0 7 = DUSTSTORM OR SANDSTORM:
VSBY 1/2 MILE OR LESS
8 = SMOKE OR HAZE
9 = BLOWING SNOW
X = TORNADO

[NO. OF DAYS WITH] [WEATHER - DAYS WITH]
MAX 32 OR BELOW: 0 0.01 INCH OR MORE: 10
MAX 90 OR ABOVE: 10 0.10 INCH OR MORE: 6
MIN 32 OR BELOW: 0 0.50 INCH OR MORE: 2
MIN 0 OR BELOW: 0 1.00 INCH OR MORE: 1

[HDD (BASE 65)]
TOTAL THIS MO. 0 CLEAR (SCALE 0-3) 7
DPTR FM NORMAL -4 PTCLDY (SCALE 4-7) 22
TOTAL FM JUL 1 0 CLOUDY (SCALE 8-10) 2
DPTR FM NORMAL -4

[CDD (BASE 65)]
TOTAL THIS MO. 382
DPTR FM NORMAL 99 [PRESSURE DATA]
TOTAL FM JAN 1 545 HIGHEST SLP M ON M
DPTR FM NORMAL 43 LOWEST SLP 29.73 ON M

[REMARKS]
#FINAL-07-19#

Explanation of the Preliminary Monthly Climate Data (F6) Product

These data are preliminary and have not undergone final quality control by the National Climatic Data Center (NCDC). Therefore, these data are subject to revision. Final and certified climate data can be accessed at the NCDC - <http://www.ncdc.noaa.gov>.

WFO Monthly/Daily Climate Data

000
 CXUS55 KLOT 010700
 CF60RD
 PRELIMINARY LOCAL CLIMATOLOGICAL DATA (WS FORM: F-6)

STATION: CHICAGO-OHARE
 MONTH: AUGUST
 YEAR: 2019
 LATITUDE: 41 58 N
 LONGITUDE: 87 54 W

TEMPERATURE IN F:		:PCPN:		SNOW:		WIND		:SUNSHINE:		SKY		:PK WND						
1	2	3	4	5	6A	6B	7	8	9	10	11	12	13	14	15	16	17	18
=====																		
12Z AVG MX 2MIN																		
DY	MAX	MIN	AVG	DEP	HDD	CDD	WTR	SNW	DPTH	SPD	SPD	DIR	MIN	PSBL	S-S	WX	SPD	DR
=====																		
1	80	57	69	-5	0	4	0.00	0.0	0	7.0	14	30	M	M	2		20	50
2	83	61	72	-2	0	7	0.00	0.0	0	5.4	13	80	M	M	3		19	80
3	89	63	76	2	0	11	0.00	0.0	0	3.9	12	10	M	M	5	8	14	360
4	89	70	80	6	0	15	0.00	0.0	0	4.6	14	60	M	M	5		19	80
5	90	70	80	7	0	15	0.00	0.0	0	8.3	23	330	M	M	5		32	320
6	85	67	76	3	0	11	0.01	0.0	0	6.7	16	310	M	M	7		23	300
7	88	66	77	4	0	12	0.00	0.0	0	7.8	17	270	M	M	3		23	250
8	87	67	77	4	0	12	0.01	0.0	0	10.0	22	360	M	M	3	3	30	320
9	83	62	73	0	0	8	0.00	0.0	0	5.9	14	290	M	M	2		22	330
10	86	67	77	4	0	12	0.00	0.0	0	5.4	15	110	M	M	6		19	80
11	82	67	75	2	0	10	T	0.0	0	7.4	15	190	M	M	8		22	190
12	84	71	78	5	0	13	0.50	0.0	0	4.9	14	90	M	M	9	1	18	80
13	86	67	77	4	0	12	0.19	0.0	0	6.8	20	30	M	M	8	13	25	30
14	83	66	75	2	0	10	T	0.0	0	7.2	20	20	M	M	6		26	20
15	79	63	71	-2	0	6	0.00	0.0	0	7.9	17	50	M	M	5		23	40
16	84	64	74	1	0	9	0.00	0.0	0	7.6	17	230	M	M	6		26	170
17	77	67	72	-1	0	7	0.18	0.0	0	4.8	12	100	M	M	6	138	15	190
18	82	68	75	3	0	10	0.86	0.0	0	7.8	22	230	M	M	7	13	35	230
19	85	68	77	5	0	12	T	0.0	0	4.6	13	50	M	M	6		17	50
20	76	68	72	0	0	7	0.35	0.0	0	3.7	17	70	M	M	7	13	27	260
21	83	65	74	2	0	9	0.02	0.0	0	6.2	16	260	M	M	6	3	23	270
22	76	64	70	-2	0	5	0.00	0.0	0	10.4	20	30	M	M	6		26	30
23	74	58	66	-6	0	1	0.00	0.0	0	10.2	18	30	M	M	2		30	30
24	75	60	68	-4	0	3	0.00	0.0	0	8.1	17	60	M	M	5		23	90
25	78	61	70	-2	0	5	T	0.0	0	10.2	18	100	M	M	8		25	100
26	76	64	70	-1	0	5	1.40	0.0	0	9.7	20	150	M	M	9	13	28	170
27	79	65	72	1	0	7	0.00	0.0	0	9.9	17	260	M	M	5		26	240
28	75	59	67	-4	0	2	0.00	0.0	0	11.6	24	270	M	M	2		37	250
29	84	58	71	0	0	6	0.00	0.0	0	12.7	25	230	M	M	2		40	250
30	74	59	67	-3	0	2	0.00	0.0	0	5.8	13	40	M	M	7		15	30
31	75	61	68	-2	0	3	0.11	0.0	0	9.3	18	110	M	M	8	1	23	90
=====																		
SM	2527	1993			0	251	3.63		0.0	231.8			M		169			
=====																		
AV	81.5	64.3								7.5	FASTST		M	M	5		MAX(MPH)	

Electronic Filing: Received, Clerk's Office 09/24/2020

MISC: ---> # 25 230 # 40 250

NOTES:

LAST OF SEVERAL OCCURRENCES

COLUMN 17 PEAK WIND IN M.P.H.

PRELIMINARY LOCAL CLIMATOLOGICAL DATA (WS FORM: F-6) , PAGE 2

STATION: CHICAGO-OHARE
MONTH: AUGUST
YEAR: 2019
LATITUDE: 41 58 N
LONGITUDE: 87 54 W

[TEMPERATURE DATA] [PRECIPITATION DATA] SYMBOLS USED IN COLUMN 16
AVERAGE MONTHLY: 72.9 TOTAL FOR MONTH: 3.63 1 = FOG OR MIST
DPTR FM NORMAL: 0.5 DPTR FM NORMAL: -1.27 2 = FOG REDUCING VISIBILITY
HIGHEST: 90 ON 5 GRTST 24HR 1.40 ON 26-26 TO 1/4 MILE OR LESS
LOWEST: 57 ON 1 SNOW, ICE PELLETS, HAIL 3 = THUNDER
TOTAL MONTH: 0.0 INCH 4 = ICE PELLETS
GRTST 24HR 0.0 5 = HAIL
GRTST DEPTH: 0 6 = FREEZING RAIN OR DRIZZLE
7 = DUSTSTORM OR SANDSTORM:
VSBY 1/2 MILE OR LESS
8 = SMOKE OR HAZE
9 = BLOWING SNOW
X = TORNADO

[NO. OF DAYS WITH] [WEATHER - DAYS WITH]
MAX 32 OR BELOW: 0 0.01 INCH OR MORE: 10
MAX 90 OR ABOVE: 1 0.10 INCH OR MORE: 7
MIN 32 OR BELOW: 0 0.50 INCH OR MORE: 3
MIN 0 OR BELOW: 0 1.00 INCH OR MORE: 1

[HDD (BASE 65)]
TOTAL THIS MO. 0 CLEAR (SCALE 0-3) 7
DPTR FM NORMAL -9 PTCLDY (SCALE 4-7) 21
TOTAL FM JUL 1 0 CLOUDY (SCALE 8-10) 3
DPTR FM NORMAL -13

[CDD (BASE 65)]
TOTAL THIS MO. 251
DPTR FM NORMAL 13 [PRESSURE DATA]
TOTAL FM JAN 1 796 HIGHEST SLP M ON M
DPTR FM NORMAL 56 LOWEST SLP 29.45 ON 31

[REMARKS]
#FINAL-08-19#

Explanation of the Preliminary Monthly Climate Data (F6) Product

These data are preliminary and have not undergone final quality control by the National Climatic Data Center (NCDC). Therefore, these data are subject to revision. Final and certified climate data can be accessed at the NCDC - <http://www.ncdc.noaa.gov>.

WFO Monthly/Daily Climate Data

000
 CXUS55 KLOT 010700
 CF60RD
 PRELIMINARY LOCAL CLIMATOLOGICAL DATA (WS FORM: F-6)

STATION: CHICAGO-OHARE
 MONTH: SEPTEMBER
 YEAR: 2019
 LATITUDE: 41 58 N
 LONGITUDE: 87 54 W

TEMPERATURE IN F:					:PCPN:			SNOW:		WIND			:SUNSHINE:		SKY		:PK WND		
1	2	3	4	5	6A	6B	7	8	9	10	11	12	13	14	15	16	17	18	
				DEP	HDD	CDD	WTR	SNW	DPTH	SPD	SPD	DIR	MIN	PSBL	S-S	WX	SPD	DR	
1	73	62	68	-2	0	3	0.34	0.0	0	4.5	14	90	M	M	8	1	17	90	
2	82	61	72	2	0	7	0.00	0.0	0	6.4	13	230	M	M	3	1	20	250	
3	80	67	74	5	0	9	0.22	0.0	0	12.4	30	160	M	M	7	13	41	180	
4	69	59	64	-5	1	0	0.00	0.0	0	9.0	15	30	M	M	5		19	50	
5	74	56	65	-4	0	0	0.00	0.0	0	5.0	14	100	M	M	5		17	80	
6	72	61	67	-1	0	2	0.00	0.0	0	11.1	17	350	M	M	10		23	330	
7	78	56	67	-1	0	2	0.00	0.0	0	8.2	17	300	M	M	7		24	280	
8	66	62	64	-4	1	0	0.03	0.0	0	8.3	14	80	M	M	10		19	60	
9	76	62	69	2	0	4	0.02	0.0	0	7.6	16	150	M	M	8		23	150	
10	90	71	81	14	0	16	0.00	0.0	0	9.3	22	200	M	M	8		34	200	
11	89	68	79	12	0	14	0.19	0.0	0	9.2	26	330	M	M	8	13	35	330	
12	78	63	71	5	0	6	0.28	0.0	0	8.1	15	330	M	M	8	123	20	70	
13	77	62	70	4	0	5	1.35	0.0	0	11.9	26	260	M	M	5	13	40	280	
14	80	56	68	3	0	3	0.06	0.0	0	7.7	20	190	M	M	3	3	31	190	
15	78	63	71	6	0	6	0.43	0.0	0	8.1	18	200	M	M	9	13	26	210	
16	74	64	69	4	0	4	0.00	0.0	0	7.9	14	10	M	M	8	18	19	30	
17	78	65	72	8	0	7	0.00	0.0	0	6.1	13	100	M	M	8	1	17	70	
18	82	62	72	8	0	7	0.00	0.0	0	7.4	14	150	M	M	4		19	160	
19	83	63	73	10	0	8	0.01	0.0	0	5.6	14	110	M	M	6		18	110	
20	84	68	76	13	0	11	0.00	0.0	0	3.8	12	210	M	M	7		15	210	
21	78	71	75	13	0	10	0.17	0.0	0	12.1	25	200	M	M	8	1	38	180	
22	77	66	72	10	0	7	1.47	0.0	0	10.1	23	210	M	M	9	1	33	210	
23	74	59	67	6	0	2	T	0.0	0	8.9	20	300	M	M	4		29	270	
24	79	58	69	8	0	4	0.00	0.0	0	12.1	21	210	M	M	4		32	210	
25	79	62	71	10	0	6	T	0.0	0	12.7	21	230	M	M	8		32	220	
26	72	56	64	4	1	0	0.00	0.0	0	8.9	18	280	M	M	4		26	280	
27	69	58	64	4	1	0	2.28	0.0	0	10.6	23	190	M	M	9	13	35	170	
28	66	53	60	1	5	0	0.19	0.0	0	13.6	23	30	M	M	9	13	28	30	
29	66	60	63	4	2	0	0.57	0.0	0	7.7	17	100	M	M	10	1	23	90	
30	85	63	74	16	0	9	0.00	0.0	0	8.7	17	200	M	M	7	12	25	200	
SM	2308	1857			11	152	7.61		0.0	263.0			M		209				
AV	76.9	61.9								8.8	FASTST		M	M	7		MAX(MPH)		
MISC											----	#	30	160			#	41	180

Electronic Filing: Received, Clerk's Office 09/24/2020

NOTES:

LAST OF SEVERAL OCCURRENCES

COLUMN 17 PEAK WIND IN M.P.H.

PRELIMINARY LOCAL CLIMATOLOGICAL DATA (WS FORM: F-6) , PAGE 2

STATION: CHICAGO-OHARE
 MONTH: SEPTEMBER
 YEAR: 2019
 LATITUDE: 41 58 N
 LONGITUDE: 87 54 W

[TEMPERATURE DATA]

AVERAGE MONTHLY: 69.4
 DPTR FM NORMAL: 4.8
 HIGHEST: 90 ON 10
 LOWEST: 53 ON 28

[PRECIPITATION DATA]

TOTAL FOR MONTH: 7.61
 DPTR FM NORMAL: 4.40
 GRTST 24HR 2.28 ON 27-27
 SNOW, ICE PELLETS, HAIL
 TOTAL MONTH: 0.0 INCH
 GRTST 24HR 0.0
 GRTST DEPTH: 0

SYMBOLS USED IN COLUMN 16

1 = FOG OR MIST
 2 = FOG REDUCING VISIBILITY
 TO 1/4 MILE OR LESS
 3 = THUNDER
 4 = ICE PELLETS
 5 = HAIL
 6 = FREEZING RAIN OR DRIZZLE
 7 = DUSTSTORM OR SANDSTORM:
 VSBY 1/2 MILE OR LESS
 8 = SMOKE OR HAZE
 9 = BLOWING SNOW
 X = TORNADO

[NO. OF DAYS WITH]

MAX 32 OR BELOW: 0
 MAX 90 OR ABOVE: 1
 MIN 32 OR BELOW: 0
 MIN 0 OR BELOW: 0

[WEATHER - DAYS WITH]

0.01 INCH OR MORE: 15
 0.10 INCH OR MORE: 11
 0.50 INCH OR MORE: 4
 1.00 INCH OR MORE: 3

[HDD (BASE 65)]

TOTAL THIS MO. 11
 DPTR FM NORMAL -94
 TOTAL FM JUL 1 11
 DPTR FM NORMAL -107

CLEAR (SCALE 0-3) 2
 PTCLDY (SCALE 4-7) 19
 CLOUDY (SCALE 8-10) 9

[CDD (BASE 65)]

TOTAL THIS MO. 152
 DPTR FM NORMAL 60
 TOTAL FM JAN 1 948
 DPTR FM NORMAL 116

[PRESSURE DATA]

HIGHEST SLP M ON M
 LOWEST SLP 29.18 ON 30

[REMARKS]

#FINAL-09-19#

Explanation of the Preliminary Monthly Climate Data (F6) Product

These data are preliminary and have not undergone final quality control by the National Climatic Data Center (NCDC). Therefore, these data are subject to revision. Final and certified climate data can be accessed at the NCDC - <http://www.ncdc.noaa.gov>.

WFO Monthly/Daily Climate Data

000
 CXUS55 KLOT 011527
 CF60RD
 PRELIMINARY LOCAL CLIMATOLOGICAL DATA (WS FORM: F-6)

STATION: CHICAGO-OHARE
 MONTH: OCTOBER
 YEAR: 2019
 LATITUDE: 41 58 N
 LONGITUDE: 87 54 W

TEMPERATURE IN F:		:PCPN:		SNOW:		WIND		:SUNSHINE:		SKY		:PK WND						
1	2	3	4	5	6A	6B	7	8	9	10	11	12	13	14	15	16	17	18
=====																		
12Z AVG MX 2MIN																		
DY	MAX	MIN	AVG	DEP	HDD	CDD	WTR	SNW	DPTH	SPD	SPD	DIR	MIN	PSBL	S-S	WX	SPD	DR
=====																		
1	86	68	77	19	0	12	0.00	0.0	0	10.1	23	10	M	M	8		33	360
2	68	57	63	5	2	0	1.76	0.0	0	10.6	18	20	M	M	10	13	25	30
3	67	49	58	1	7	0	0.57	0.0	0	10.2	20	300	M	M	7	13	27	280
4	58	45	52	-5	13	0	T	0.0	0	10.9	21	20	M	M	7		25	20
5	63	48	56	0	9	0	0.27	0.0	0	9.4	20	160	M	M	8	1	28	170
6	67	49	58	2	7	0	0.00	0.0	0	9.7	17	270	M	M	6		24	290
7	69	48	59	3	6	0	0.00	0.0	0	7.3	16	290	M	M	1		25	270
8	70	46	58	3	7	0	0.00	0.0	0	4.2	12	180	M	M	0	8	16	230
9	70	50	60	5	5	0	0.00	0.0	0	7.8	15	90	M	M	4		20	80
10	70	54	62	8	3	0	0.19	0.0	0	8.8	20	150	M	M	9	1	29	160
11	67	39	53	-1	12	0	0.59	0.0	0	12.4	22	250	M	M	9	13	32	250
12	54	35	45	-9	20	0	0.00	0.0	0	13.9	28	210	M	M	4	8	39	230
13	52	37	45	-9	20	0	0.00	0.0	0	10.5	26	250	M	M	8		37	240
14	54	37	46	-7	19	0	0.00	0.0	0	6.9	15	250	M	M	3		22	270
15	62	41	52	-1	13	0	T	0.0	0	10.6	28	300	M	M	6	1	42	300
16	52	41	47	-5	18	0	0.00	0.0	0	14.0	29	320	M	M	8		40	320
17	54	40	47	-5	18	0	0.00	0.0	0	5.5	13	350	M	M	6		17	350
18	59	38	49	-3	16	0	0.00	0.0	0	7.0	16	160	M	M	4		20	180
19	68	44	56	4	9	0	T	0.0	0	7.9	16	200	M	M	7		23	210
20	63	48	56	5	9	0	0.00	0.0	0	7.4	13	300	M	M	6	1	17	290
21	67	50	59	8	6	0	0.05	0.0	0	15.6	32	210	M	M	7	12	54	230
22	51	44	48	-2	17	0	0.01	0.0	0	17.3	29	240	M	M	8		45	240
23	58	39	49	-1	16	0	0.02	0.0	0	8.7	20	350	M	M	6		26	360
24	50	42	46	-4	19	0	0.00	0.0	0	6.2	14	350	M	M	9		18	360
25	48	37	43	-7	22	0	0.00	0.0	0	3.8	9	240	M	M	9		14	300
26	48	36	42	-7	23	0	2.18	0.0	0	12.6	28	20	M	M	9	18	37	20
27	58	42	50	1	15	0	0.04	0.0	0	9.7	22	310	M	M	3	1	35	290
28	49	41	45	-3	20	0	T	0.0	0	3.9	12	90	M	M	7	1	15	100
29	45	35	40	-8	25	0	0.15	0.0	0	8.3	24	350	M	M	9	1	31	340
30	41	32	37	-11	28	0	0.62	1.2	1	12.3	23	10	M	M	10	1	29	20
31	33	25	29	-18	36	0	0.31	3.4	0	14.9	25	310	M	M	8	14	34	310
=====																		
SM	1821	1337			440	12	6.76		4.6	298.4			M		206			
=====																		
AV	58.7	43.1								9.6	FASTST		M	M	7		MAX(MPH)	

Electronic Filing: Received, Clerk's Office 09/24/2020

MISC: ---> # 32 210 # 34 230

NOTES:

LAST OF SEVERAL OCCURRENCES

COLUMN 17 PEAK WIND IN M.P.H.

PRELIMINARY LOCAL CLIMATOLOGICAL DATA (WS FORM: F-6) , PAGE 2

STATION: CHICAGO-OHARE
MONTH: OCTOBER
YEAR: 2019
LATITUDE: 41 58 N
LONGITUDE: 87 54 W

[TEMPERATURE DATA] [PRECIPITATION DATA] SYMBOLS USED IN COLUMN 16
AVERAGE MONTHLY: 50.9
DPTR FM NORMAL: -1.6
HIGHEST: 86 ON 1
LOWEST: 25 ON 31
TOTAL FOR MONTH: 6.76
DPTR FM NORMAL: 3.61
GRTST 24HR 2.18 ON 26-26
SNOW, ICE PELLETS, HAIL
TOTAL MONTH: 4.6 INCHES
GRTST 24HR 3.4 ON 31-31
GRTST DEPTH: 1 ON 30
1 = FOG OR MIST
2 = FOG REDUCING VISIBILITY TO 1/4 MILE OR LESS
3 = THUNDER
4 = ICE PELLETS
5 = HAIL
6 = FREEZING RAIN OR DRIZZLE
7 = DUSTSTORM OR SANDSTORM: VSBY 1/2 MILE OR LESS
8 = SMOKE OR HAZE
9 = BLOWING SNOW
X = TORNADO
[NO. OF DAYS WITH] [WEATHER - DAYS WITH]
MAX 32 OR BELOW: 0
MAX 90 OR ABOVE: 0
MIN 32 OR BELOW: 2
MIN 0 OR BELOW: 0
0.01 INCH OR MORE: 13
0.10 INCH OR MORE: 9
0.50 INCH OR MORE: 5
1.00 INCH OR MORE: 2

[HDD (BASE 65)]
TOTAL THIS MO. 440
DPTR FM NORMAL 43
TOTAL FM JUL 1 451
DPTR FM NORMAL -64
CLEAR (SCALE 0-3) 3
PTCLDY (SCALE 4-7) 18
CLOUDY (SCALE 8-10) 10

[CDD (BASE 65)]
TOTAL THIS MO. 12
DPTR FM NORMAL 1
TOTAL FM JAN 1 960
DPTR FM NORMAL 117
[PRESSURE DATA]
HIGHEST SLP 30.41 ON 4
LOWEST SLP 29.39 ON 21

[REMARKS]
#FINAL-10-19#

Explanation of the Preliminary Monthly Climate Data (F6) Product

These data are preliminary and have not undergone final quality control by the National Climatic Data Center (NCDC). Therefore, these data are subject to revision. Final and certified climate data can be accessed at the NCDC - <http://www.ncdc.noaa.gov>.

WFO Monthly/Daily Climate Data

000
 CXUS55 KLOT 011401
 CF60RD
 PRELIMINARY LOCAL CLIMATOLOGICAL DATA (WS FORM: F-6)

STATION: CHICAGO-OHARE
 MONTH: NOVEMBER
 YEAR: 2019
 LATITUDE: 41 58 N
 LONGITUDE: 87 54 W

TEMPERATURE IN F:		:PCPN:		SNOW:		WIND		:SUNSHINE:		SKY		:PK WND						
1	2	3	4	5	6A	6B	7	8	9	10	11	12	13	14	15	16	17	18
										12Z	AVG	MX	2MIN					
DY	MAX	MIN	AVG	DEP	HDD	CDD	WTR	SNW	DPTH	SPD	SPD	DIR	MIN	PSBL	S-S	WX	SPD	DR
1	44	23	34	-13	31	0	0.01	0.0	2	9.7	20	200	M	M	6	1	29	280
2	42	31	37	-10	28	0	0.00	0.0	0	10.6	22	260	M	M	9	1	36	250
3	53	30	42	-4	23	0	T	0.0	0	7.9	23	190	M	M	8		31	180
4	51	38	45	-1	20	0	0.00	0.0	0	10.7	20	260	M	M	8		27	260
5	40	30	35	-10	30	0	0.00	0.0	0	7.6	20	280	M	M	3		30	240
6	55	29	42	-3	23	0	0.01	T	0	11.3	24	210	M	M	10	146	36	200
7	31	20	26	-18	39	0	T	0.1	0	11.2	20	350	M	M	4	1	27	330
8	32	16	24	-20	41	0	0.00	0.0	0	7.1	14	210	M	M	6	8	19	210
9	46	27	37	-7	28	0	0.00	0.0	0	10.2	18	210	M	M	8		26	190
10	43	33	38	-5	27	0	0.04	T	0	8.6	16	360	M	M	10	1	19	360
11	33	13	23	-20	42	0	0.25	3.4	2	16.8	26	350	M	M	8	19	33	350
12	17	7	12	-30	53	0	0.00	0.0	3	9.3	21	310	M	M	2		29	300
13	27	11	19	-23	46	0	T	T	2	11.6	21	180	M	M	10		31	180
14	30	24	27	-14	38	0	0.01	0.2	2	7.2	14	250	M	M	9	1	20	280
15	38	22	30	-11	35	0	0.00	0.0	2	6.1	12	250	M	M	5		16	260
16	42	26	34	-6	31	0	0.00	0.0	1	5.4	13	130	M	M	5	18	16	120
17	40	27	34	-6	31	0	0.04	0.0	0	6.4	12	200	M	M	9	1	16	200
18	40	34	37	-2	28	0	T	0.0	0	5.1	10	310	M	M	10	1	14	300
19	41	35	38	-1	27	0	0.01	0.0	0	2.8	8	250	M	M	10	18	11	220
20	47	38	43	5	22	0	0.00	0.0	0	6.5	17	170	M	M	10	18	24	170
21	54	37	46	8	19	0	0.51	0.0	0	14.8	29	250	M	M	10	1	49	250
22	38	28	33	-4	32	0	0.00	0.0	0	6.8	17	10	M	M	5		23	320
23	40	24	32	-5	33	0	0.00	0.0	0	6.2	12	240	M	M	5		18	240
24	50	32	41	5	24	0	0.00	0.0	0	9.3	16	230	M	M	6		24	270
25	53	37	45	9	20	0	0.00	0.0	0	7.2	14	220	M	M	6		20	220
26	50	32	41	6	24	0	0.37	0.0	0	7.7	16	50	M	M	8	13	21	50
27	55	33	44	9	21	0	0.25	0.0	0	21.1	38	260	M	M	8	1	60	240
28	37	31	34	0	31	0	T	0.0	0	8.3	21	320	M	M	10	1	28	300
29	40	33	37	3	28	0	T	T	0	6.5	17	120	M	M	10	1	22	120
30	40	36	38	5	27	0	0.37	0.0	0	13.1	28	110	M	M	10	13	36	120
SM	1249	837			902	0	1.87		3.7	273.1			M		228			
AV	41.6	27.9								9.1	FASTST		M	M	8		MAX(MPH)	
MISC																	# 60	240

NOTES:

LAST OF SEVERAL OCCURRENCES

COLUMN 17 PEAK WIND IN M.P.H.

PRELIMINARY LOCAL CLIMATOLOGICAL DATA (WS FORM: F-6) , PAGE 2

STATION: CHICAGO-OHARE
 MONTH: NOVEMBER
 YEAR: 2019
 LATITUDE: 41 58 N
 LONGITUDE: 87 54 W

[TEMPERATURE DATA]

[PRECIPITATION DATA]

SYMBOLS USED IN COLUMN 16

AVERAGE MONTHLY: 34.8
 DPTR FM NORMAL: -5.5
 HIGHEST: 55 ON 27, 6
 LOWEST: 7 ON 12

TOTAL FOR MONTH: 1.87
 DPTR FM NORMAL: -1.28
 GRTST 24HR 0.51 ON 21-21
 SNOW, ICE PELLETS, HAIL
 TOTAL MONTH: 3.7 INCHES
 GRTST 24HR 3.4 ON 11-11
 GRTST DEPTH: 3 ON 12

1 = FOG OR MIST
 2 = FOG REDUCING VISIBILITY
 TO 1/4 MILE OR LESS
 3 = THUNDER
 4 = ICE PELLETS
 5 = HAIL
 6 = FREEZING RAIN OR DRIZZLE
 7 = DUSTSTORM OR SANDSTORM:
 VSBY 1/2 MILE OR LESS
 8 = SMOKE OR HAZE
 9 = BLOWING SNOW
 X = TORNADO

[NO. OF DAYS WITH]

[WEATHER - DAYS WITH]

MAX 32 OR BELOW: 5
 MAX 90 OR ABOVE: 0
 MIN 32 OR BELOW: 20
 MIN 0 OR BELOW: 0

0.01 INCH OR MORE: 11
 0.10 INCH OR MORE: 5
 0.50 INCH OR MORE: 1
 1.00 INCH OR MORE: 0

[HDD (BASE 65)]

TOTAL THIS MO. 902
 DPTR FM NORMAL 161
 TOTAL FM JUL 1 1353
 DPTR FM NORMAL 97

CLEAR (SCALE 0-3) 1
 PTCLDY (SCALE 4-7) 14
 CLOUDY (SCALE 8-10) 15

[CDD (BASE 65)]

TOTAL THIS MO. 0
 DPTR FM NORMAL 0
 TOTAL FM JAN 1 960
 DPTR FM NORMAL 117

[PRESSURE DATA]

HIGHEST SLP 30.54 ON 12
 LOWEST SLP 29.25 ON 27

[REMARKS]

#FINAL-11-19#

Explanation of the Preliminary Monthly Climate Data (F6) Product

These data are preliminary and have not undergone final quality control by the National Climatic Data Center (NCDC). Therefore, these data are subject to revision. Final and certified climate data can be accessed at the NCDC - <http://www.ncdc.noaa.gov>.

WFO Monthly/Daily Climate Data

000
 CXUS55 KLOT 010700
 CF60RD
 PRELIMINARY LOCAL CLIMATOLOGICAL DATA (WS FORM: F-6)

STATION: CHICAGO-OHARE
 MONTH: DECEMBER
 YEAR: 2019
 LATITUDE: 41 58 N
 LONGITUDE: 87 54 W

TEMPERATURE IN F:					:PCPN:			SNOW:		WIND			:SUNSHINE:		SKY		:PK WND		
1	2	3	4	5	6A	6B	7	8	9	10	11	12	13	14	15	16	17	18	
				DEP	HDD	CDD	WTR	SNW	DPTH	SPD	SPD	DIR	MIN	PSBL	S-S	WX	SPD	DR	
1	41	31	36	3	29	0	0.11	0.1	0	10.1	20	340	M	M	9	1	28	330	
2	35	29	32	0	33	0	0.00	0.0	0	10.2	21	340	M	M	9		29	320	
3	40	29	35	3	30	0	0.00	0.0	0	11.9	18	240	M	M	7		26	220	
4	43	31	37	6	28	0	0.00	0.0	0	12.1	25	300	M	M	3		38	300	
5	45	27	36	5	29	0	0.00	0.0	0	6.8	13	180	M	M	4		18	210	
6	42	27	35	4	30	0	0.00	0.0	0	9.9	26	360	M	M	5		35	350	
7	37	25	31	1	34	0	0.00	0.0	0	8.2	16	200	M	M	7		22	200	
8	47	34	41	11	24	0	0.00	0.0	0	10.2	20	200	M	M	9	18	28	200	
9	47	24	36	7	29	0	0.05	0.0	0	13.0	28	270	M	M	10	1	44	280	
10	24	14	19	-10	46	0		T	T	0	11.8	22	260	M	M	5		31	260
11	24	13	19	-10	46	0		T	0.1	0	7.3	20	250	M	M	5	1	29	260
12	45	19	32	4	33	0	0.00	0.0	0	12.2	24	190	M	M	9		35	190	
13	45	34	40	12	25	0	0.00	0.0	0	4.9	13	200	M	M	8		19	200	
14	35	24	30	2	35	0	0.00	0.0	0	9.3	20	300	M	M	10	1	29	280	
15	26	19	23	-5	42	0		T	T	0	6.0	16	310	M	M	9	1	21	310
16	30	24	27	0	38	0	0.01	0.3	T	6.7	14	350	M	M	9	1	17	350	
17	29	19	24	-3	41	0		T	T	0	10.7	21	270	M	M	6	8	28	280
18	27	10	19	-8	46	0		T	T	0	8.8	17	330	M	M	5		25	330
19	35	15	25	-1	40	0	0.00	0.0	0	8.5	20	220	M	M	3	1	28	220	
20	41	23	32	6	33	0	0.00	0.0	0	5.6	13	180	M	M	9	18	17	180	
21	47	32	40	14	25	0	0.00	0.0	0	7.7	15	220	M	M	1		20	220	
22	52	33	43	17	22	0	0.00	0.0	0	10.0	16	220	M	M	3		23	200	
23	52	33	43	17	22	0	0.00	0.0	0	7.6	15	250	M	M	8	1	22	240	
24	55	30	43	17	22	0	0.00	0.0	0	8.1	17	170	M	M	9	128	24	170	
25	57	37	47	22	18	0	0.00	0.0	0	8.7	17	220	M	M	8		26	210	
26	61	37	49	24	16	0	0.00	0.0	0	11.1	18	220	M	M	9		30	210	
27	37	28	33	8	32	0	0.00	0.0	0	7.2	17	260	M	M	7	1	24	250	
28	48	27	38	13	27	0	0.28	0.0	0	7.0	14	130	M	M	9	138	17	110	
29	57	47	52	27	13	0	0.93	0.0	0	10.9	22	100	M	M	10	1	30	190	
30	47	27	37	12	28	0	0.09	0.7	0	17.6	30	240	M	M	10	1	45	240	
31	28	24	26	2	39	0	0.08	0.8	2	14.5	30	250	M	M	9	1	42	240	
SM	1279	826			955	0	1.55		2.0	294.6			M		224				
AV	41.3	26.7								9.5	FASTST		M	M	7		MAX(MPH)		

Electronic Filing: Received, Clerk's Office 09/24/2020

MISC: ---> # 30 240 # 45 240

NOTES:

LAST OF SEVERAL OCCURRENCES

COLUMN 17 PEAK WIND IN M.P.H.

PRELIMINARY LOCAL CLIMATOLOGICAL DATA (WS FORM: F-6) , PAGE 2

STATION: CHICAGO-OHARE
MONTH: DECEMBER
YEAR: 2019
LATITUDE: 41 58 N
LONGITUDE: 87 54 W

[TEMPERATURE DATA] [PRECIPITATION DATA] SYMBOLS USED IN COLUMN 16
AVERAGE MONTHLY: 34.0 TOTAL FOR MONTH: 1.55 1 = FOG OR MIST
DPTR FM NORMAL: 6.3 DPTR FM NORMAL: -0.70 2 = FOG REDUCING VISIBILITY
HIGHEST: 61 ON 26 GRTST 24HR 0.93 ON 29-29 TO 1/4 MILE OR LESS
LOWEST: 10 ON 18 3 = THUNDER
SNOW, ICE PELLETS, HAIL 4 = ICE PELLETS
TOTAL MONTH: 2.0 INCHES 5 = HAIL
GRTST 24HR 0.8 ON 31-31 6 = FREEZING RAIN OR DRIZZLE
GRTST DEPTH: 2 ON 31 7 = DUSTSTORM OR SANDSTORM:
VSBY 1/2 MILE OR LESS
8 = SMOKE OR HAZE
[NO. OF DAYS WITH] [WEATHER - DAYS WITH] 9 = BLOWING SNOW
X = TORNADO
MAX 32 OR BELOW: 7 0.01 INCH OR MORE: 7
MAX 90 OR ABOVE: 0 0.10 INCH OR MORE: 3
MIN 32 OR BELOW: 24 0.50 INCH OR MORE: 1
MIN 0 OR BELOW: 0 1.00 INCH OR MORE: 0

[HDD (BASE 65)]
TOTAL THIS MO. 955 CLEAR (SCALE 0-3) 4
DPTR FM NORMAL -200 PTCLDY (SCALE 4-7) 11
TOTAL FM JUL 1 2308 CLOUDY (SCALE 8-10) 16
DPTR FM NORMAL -103

[CDD (BASE 65)]
TOTAL THIS MO. 0
DPTR FM NORMAL 0 [PRESSURE DATA]
TOTAL FM JAN 1 960 HIGHEST SLP M ON M
DPTR FM NORMAL 117 LOWEST SLP 29.32 ON 1

[REMARKS]
#FINAL-12-19#

Explanation of the Preliminary Monthly Climate Data (F6) Product

These data are preliminary and have not undergone final quality control by the National Climatic Data Center (NCDC). Therefore, these data are subject to revision. Final and certified climate data can be accessed at the NCDC - <http://www.ncdc.noaa.gov>.

WFO Monthly/Daily Climate Data

173
 CXUS55 KLOT 010700
 CF60RD
 PRELIMINARY LOCAL CLIMATOLOGICAL DATA (WS FORM: F-6)

STATION: CHICAGO-OHARE
 MONTH: JANUARY
 YEAR: 2020
 LATITUDE: 41 58 N
 LONGITUDE: 87 54 W

TEMPERATURE IN F:					:PCPN:			SNOW:		WIND		:SUNSHINE:			SKY		:PK WND	
1	2	3	4	5	6A	6B	7	8	9	10	11	12	13	14	15	16	17	18
				DEP	HDD	CDD	WTR	SNW	DPTH	SPD	SPD	DIR	MIN	PSBL	S-S	WX	SPD	DR
1	42	21	32	8	33	0	0.00	0.0	0	11.9	22	190	M	M	3		34	190
2	48	37	43	19	22	0	0.00	0.0	0	11.7	22	190	M	M	5		32	190
3	41	33	37	13	28	0	0.00	0.0	0	6.1	12	330	M	M	10		14	350
4	33	26	30	6	35	0	0.03	0.5	1	9.2	16	310	M	M	10	18	24	300
5	42	24	33	9	32	0	0.00	0.0	0	13.8	26	280	M	M	8		37	220
6	42	27	35	11	30	0	0.00	0.0	0	9.5	16	260	M	M	5		24	270
7	40	28	34	10	31	0	0.00	0.0	0	10.7	20	270	M	M	7		30	270
8	29	14	22	-2	43	0	0.00	0.0	0	11.2	23	300	M	M	4		32	300
9	50	23	37	13	28	0	0.02	0.0	0	16.1	26	200	M	M	9		39	200
10	50	36	43	19	22	0	0.84	0.0	0	11.4	26	20	M	M	10	12	34	30
11	37	25	31	7	34	0	0.37	2.1	0	25.0	39	20	M	M	10	129	52	10
12	31	23	27	3	38	0	T	T	2	6.5	16	150	M	M	10	168	22	160
13	33	31	32	8	33	0	T	0.2	2	8.3	20	270	M	M	8	1	26	280
14	39	25	32	8	33	0	0.00	0.0	1	8.5	22	240	M	M	8	1	29	230
15	36	25	31	7	34	0	T	0.0	0	8.0	22	320	M	M	8	1	31	290
16	29	11	20	-4	45	0	T	T	0	11.7	22	310	M	M	6		29	290
17	29	11	20	-3	45	0	0.37	3.1	0	10.5	25	120	M	M	10	12469	34	120
18	35	5	20	-3	45	0	0.40	T	2	15.8	31	270	M	M	9	168	46	270
19	19	2	11	-12	54	0	T	T	2	13.0	26	260	M	M	7		39	280
20	31	17	24	1	41	0	T	T	2	6.8	12	310	M	M	6		15	310
21	29	15	22	-2	43	0	0.00	0.0	2	7.7	17	230	M	M	3		24	230
22	34	24	29	5	36	0	T	T	2	12.2	18	180	M	M	10		29	190
23	34	29	32	8	33	0	0.17	0.9	2	7.6	15	190	M	M	10	1	22	180
24	37	32	35	11	30	0	0.40	T	1	4.7	13	80	M	M	10	12	17	80
25	34	32	33	9	32	0	0.12	0.4	1	8.2	15	260	M	M	10	16	21	230
26	33	27	30	6	35	0	T	T	1	9.3	15	230	M	M	10	1	20	250
27	35	27	31	7	34	0	T	T	0	5.8	9	340	M	M	10	16	12	270
28	33	31	32	8	33	0	T	T	0	5.8	12	300	M	M	10	1	17	300
29	34	30	32	8	33	0	T	T	0	4.7	9	20	M	M	10	8	11	20
30	35	32	34	10	31	0	0.00	0.0	0	3.6	9	170	M	M	10	8	14	190
31	37	32	35	11	30	0	0.08	0.6	0	5.3	10	170	M	M	10	18	14	160
SM	1111	755			1076	0	2.80		7.8	300.6			M		256			
AV	35.8	24.4							9.7	FASTST			M	M	8		MAX(MPH)	

Electronic Filing: Received, Clerk's Office 09/24/2020

MISC: ---> # 39 '20 # 32 10

NOTES:

LAST OF SEVERAL OCCURRENCES

COLUMN 17 PEAK WIND IN M.P.H.

PRELIMINARY LOCAL CLIMATOLOGICAL DATA (WS FORM: F-6) , PAGE 2

STATION: CHICAGO-OHARE
MONTH: JANUARY
YEAR: 2020
LATITUDE: 41 58 N
LONGITUDE: 87 54 W

[TEMPERATURE DATA] [PRECIPITATION DATA] SYMBOLS USED IN COLUMN 16
AVERAGE MONTHLY: 30.1 TOTAL FOR MONTH: 2.80 1 = FOG OR MIST
DPTR FM NORMAL: 6.3 DPTR FM NORMAL: 1.07 2 = FOG REDUCING VISIBILITY
HIGHEST: 50 ON 10, 9 GRTST 24HR 0.84 ON 10-10 TO 1/4 MILE OR LESS
LOWEST: 2 ON 19 3 = THUNDER
SNOW, ICE PELLETS, HAIL 4 = ICE PELLETS
TOTAL MONTH: 7.8 INCHES 5 = HAIL
GRTST 24HR 3.1 ON 17-17 6 = FREEZING RAIN OR DRIZZLE
GRTST DEPTH: 2 ON 23,22 7 = DUSTSTORM OR SANDSTORM:
VSBY 1/2 MILE OR LESS
8 = SMOKE OR HAZE
9 = BLOWING SNOW
X = TORNADO
[NO. OF DAYS WITH] [WEATHER - DAYS WITH]
MAX 32 OR BELOW: 7 0.01 INCH OR MORE: 10
MAX 90 OR ABOVE: 0 0.10 INCH OR MORE: 7
MIN 32 OR BELOW: 28 0.50 INCH OR MORE: 1
MIN 0 OR BELOW: 0 1.00 INCH OR MORE: 0

[HDD (BASE 65)]
TOTAL THIS MO. 1076 CLEAR (SCALE 0-3) 1
DPTR FM NORMAL -203 PTCLDY (SCALE 4-7) 12
TOTAL FM JUL 1 3384 CLOUDY (SCALE 8-10) 18
DPTR FM NORMAL -306

[CDD (BASE 65)]
TOTAL THIS MO. 0
DPTR FM NORMAL 0 [PRESSURE DATA]
TOTAL FM JAN 1 0 HIGHEST SLP M ON M
DPTR FM NORMAL 0 LOWEST SLP 29.31 ON 31

[REMARKS]
#FINAL-01-20#

Explanation of the Preliminary Monthly Climate Data (F6) Product

These data are preliminary and have not undergone final quality control by the National Climatic Data Center (NCDC). Therefore, these data are subject to revision. Final and certified climate data can be accessed at the NCDC - <http://www.ncdc.noaa.gov>.

WFO Monthly/Daily Climate Data

000
 CXUS55 KLOT 011347
 CF60RD
 PRELIMINARY LOCAL CLIMATOLOGICAL DATA (WS FORM: F-6)

STATION: CHICAGO-OHARE
 MONTH: FEBRUARY
 YEAR: 2020
 LATITUDE: 41 58 N
 LONGITUDE: 87 54 W

TEMPERATURE IN F:		:PCPN:		SNOW:		WIND		:SUNSHINE:		SKY		:PK WND						
1	2	3	4	5	6A	6B	7	8	9	10	11	12	13	14	15	16	17	18
=====																		
12Z AVG MX 2MIN																		
DY	MAX	MIN	AVG	DEP	HDD	CDD	WTR	SNW	DPTH	SPD	SPD	DIR	MIN	PSBL	S-S	WX	SPD	DR
=====																		
1	38	34	36	12	29	0	0.01	T	0	11.5	20	250	M	M	10	18	28	270
2	52	35	44	20	21	0	0.00	0.0	0	14.4	26	260	M	M	7		43	270
3	48	30	39	14	26	0	0.00	0.0	0	9.7	21	10	M	M	7		27	20
4	39	31	35	10	30	0	0.00	0.0	0	21.7	32	20	M	M	10		41	20
5	33	27	30	5	35	0	0.07	1.0	0	12.7	21	40	M	M	10	1	27	70
6	30	27	29	4	36	0	0.05	1.4	1	12.9	22	30	M	M	10	1	28	40
7	38	24	31	6	34	0	T	0.2	2	7.8	15	270	M	M	8		21	250
8	37	28	33	7	32	0	T	T	0	6.3	14	250	M	M	9		20	240
9	37	25	31	5	34	0	0.14	1.0	0	10.1	21	210	M	M	9	1	31	200
10	39	26	33	7	32	0	0.00	0.0	0	5.8	18	340	M	M	8	8	25	330
11	35	26	31	5	34	0	0.00	0.0	0	9.7	22	270	M	M	6	18	35	280
12	37	24	31	4	34	0	0.18	2.0	0	5.3	15	200	M	M	9	1	20	220
13	32	4	18	-9	47	0	0.03	1.5	3	12.4	23	350	M	M	8	19	30	350
14	15	-2	7	-20	58	0	0.00	0.0	3	7.8	14	170	M	M	0		20	170
15	33	7	20	-8	45	0	T	T	3	12.7	24	210	M	M	6		33	220
16	43	20	32	4	33	0	0.00	0.0	2	3.6	8	100	M	M	3	1	13	100
17	41	28	35	7	30	0	0.13	T	1	9.1	20	120	M	M	10	138	24	120
18	39	25	32	4	33	0	T	0.0	0	13.6	26	280	M	M	6	1	38	280
19	31	16	24	-5	41	0	0.00	0.0	0	8.7	17	10	M	M	4		20	360
20	25	9	17	-12	48	0	0.00	0.0	0	8.9	17	360	M	M	2		24	350
21	38	12	25	-5	40	0	0.00	0.0	0	12.8	24	220	M	M	1		35	240
22	51	28	40	10	25	0	0.00	0.0	0	13.6	21	210	M	M	2		29	230
23	55	35	45	15	20	0	0.00	0.0	0	10.4	17	230	M	M	2		25	210
24	43	35	39	8	26	0	T	T	0	12.2	22	30	M	M	10		27	20
25	41	33	37	6	28	0	0.06	0.7	0	23.3	32	20	M	M	10	1	40	20
26	33	26	30	-1	35	0	0.10	1.0	1	16.2	26	20	M	M	10	18	35	20
27	32	21	27	-5	38	0	T	T	1	9.8	20	260	M	M	7		28	260
28	30	19	25	-7	40	0	0.00	0.0	1	9.2	18	290	M	M	4		28	330
29	37	17	27	-5	38	0	0.00	0.0	0	8.9	14	210	M	M	1		20	260
=====																		
SM	1082	670		1002	0	0.77		8.8	321.1				M		189			
=====																		
AV	37.3	23.1							11.1	FASTST	M	M	7		MAX(MPH)			
=====																		
MISC ----> # 32 20 # 43 270																		
=====																		

Electronic Filing: Received, Clerk's Office 09/24/2020

NOTES:

LAST OF SEVERAL OCCURRENCES

COLUMN 17 PEAK WIND IN M.P.H.

PRELIMINARY LOCAL CLIMATOLOGICAL DATA (WS FORM: F-6) , PAGE 2

STATION: CHICAGO-OHARE
 MONTH: FEBRUARY
 YEAR: 2020
 LATITUDE: 41 58 N
 LONGITUDE: 87 54 W

[TEMPERATURE DATA]

AVERAGE MONTHLY: 30.2
 DPTR FM NORMAL: 2.5
 HIGHEST: 55 ON 23
 LOWEST: -2 ON 14

[PRECIPITATION DATA]

TOTAL FOR MONTH: 0.77
 DPTR FM NORMAL: -1.02
 GRTST 24HR 0.18 ON 12-12
 SNOW, ICE PELLETS, HAIL
 TOTAL MONTH: 8.8 INCHES
 GRTST 24HR 2.0 ON 12-12
 GRTST DEPTH: 3 ON 15,14

SYMBOLS USED IN COLUMN 16

- 1 = FOG OR MIST
- 2 = FOG REDUCING VISIBILITY TO 1/4 MILE OR LESS
- 3 = THUNDER
- 4 = ICE PELLETS
- 5 = HAIL
- 6 = FREEZING RAIN OR DRIZZLE
- 7 = DUSTSTORM OR SANDSTORM: VSBY 1/2 MILE OR LESS
- 8 = SMOKE OR HAZE
- 9 = BLOWING SNOW
- X = TORNADO

[NO. OF DAYS WITH]

MAX 32 OR BELOW: 7
 MAX 90 OR ABOVE: 0
 MIN 32 OR BELOW: 24
 MIN 0 OR BELOW: 1

[WEATHER - DAYS WITH]

0.01 INCH OR MORE: 9
 0.10 INCH OR MORE: 4
 0.50 INCH OR MORE: 0
 1.00 INCH OR MORE: 0

[HDD (BASE 65)]

TOTAL THIS MO. 1002
 DPTR FM NORMAL -42
 TOTAL FM JUL 1 4386
 DPTR FM NORMAL -381

CLEAR (SCALE 0-3) 6
 PTCLDY (SCALE 4-7) 12
 CLOUDY (SCALE 8-10) 11

[CDD (BASE 65)]

TOTAL THIS MO. 0
 DPTR FM NORMAL 0
 TOTAL FM JAN 1 0
 DPTR FM NORMAL 0

[PRESSURE DATA]
 HIGHEST SLP 30.74 ON 20
 LOWEST SLP 29.43 ON 2

[REMARKS]

#FINAL-02-20#

Explanation of the Preliminary Monthly Climate Data (F6) Product

These data are preliminary and have not undergone final quality control by the National Climatic Data Center (NCDC). Therefore, these data are subject to revision. Final and certified climate data can be accessed at the NCDC - <http://www.ncdc.noaa.gov>.

WFO Monthly/Daily Climate Data

000
 CXUS53 KLOT 010700
 CF60RD
 PRELIMINARY LOCAL CLIMATOLOGICAL DATA (WS FORM: F-6)

STATION: CHICAGO-OHARE
 MONTH: MARCH
 YEAR: 2020
 LATITUDE: 41 58 N
 LONGITUDE: 87 54 W

TEMPERATURE IN F:		:PCPN:		SNOW:		WIND		:SUNSHINE:		SKY		:PK WND						
1	2	3	4	5	6A	6B	7	8	9	10	11	12	13	14	15	16	17	18
=====																		
12Z AVG MX 2MIN																		
DY	MAX	MIN	AVG	DEP	HDD	CDD	WTR	SNW	DPTH	SPD	SPD	DIR	MIN	PSBL	S-S	WX	SPD	DR
=====																		
1	60	30	45	13	20	0	0.00	0.0	0	12.9	24	200	M	M	7		35	200
2	50	34	42	9	23	0	0.00	0.0	0	5.9	14	250	M	M	5		18	240
3	49	32	41	8	24	0	T	T	0	11.4	26	260	M	M	6		42	270
4	49	32	41	7	24	0	T	0.0	0	7.9	17	300	M	M	4		23	310
5	53	33	43	9	22	0	T	T	0	14.4	28	200	M	M	6		44	200
6	40	28	34	0	31	0	T	T	0	14.4	28	340	M	M	6		38	310
7	53	25	39	4	26	0	0.00	0.0	0	10.8	21	200	M	M	2		28	180
8	67	42	55	20	10	0	0.00	0.0	0	16.6	25	190	M	M	5		39	210
9	57	48	53	18	12	0	0.83	0.0	0	15.6	29	230	M	M	10	1	41	230
10	51	35	43	7	22	0	T	0.0	0	8.2	18	350	M	M	7	1	23	350
11	45	36	41	5	24	0	T	0.0	0	5.9	13	260	M	M	10	18	18	260
12	58	37	48	12	17	0	0.01	0.0	0	10.8	28	310	M	M	7	18	39	290
13	50	34	42	5	23	0	0.00	0.0	0	14.1	24	280	M	M	4		35	260
14	40	33	37	0	28	0	0.01	T	0	12.4	21	30	M	M	10	15	26	20
15	42	31	37	-1	28	0	0.00	0.0	0	10.1	18	20	M	M	6		23	20
16	40	30	35	-3	30	0	0.04	T	0	5.2	10	240	M	M	9	18	15	230
17	50	36	43	5	22	0	0.00	0.0	0	7.9	16	320	M	M	7	18	22	300
18	46	39	43	4	22	0	0.29	0.0	0	6.9	15	90	M	M	10	1	22	10
19	64	41	53	14	12	0	0.22	0.0	0	9.6	22	210	M	M	10	128	31	200
20	63	31	47	8	18	0	0.06	0.0	0	15.4	24	300	M	M	9	1	34	300
21	35	26	31	-9	34	0	0.00	0.0	0	10.3	21	20	M	M	6		29	30
22	37	26	32	-8	33	0	0.16	2.2	0	6.9	17	120	M	M	8	1	22	120
23	45	33	39	-1	26	0	0.05	1.0	3	4.6	12	300	M	M	8	18	14	290
24	49	34	42	1	23	0	0.00	0.0	0	6.5	13	90	M	M	8	18	M	M
25	58	32	45	4	20	0	0.00	0.0	0	7.4	17	210	M	M	4	18	25	180
26	52	38	45	3	20	0	T	0.0	0	10.7	18	20	M	M	10	1	23	210
27	50	37	44	2	21	0	0.33	0.0	0	10.2	18	40	M	M	10	138	22	30
28	67	44	56	14	9	0	1.48	0.0	0	9.2	28	200	M	M	10	13	40	190
29	63	44	54	12	11	0	T	0.0	0	20.9	35	250	M	M	9		55	270
30	51	39	45	2	20	0	T	0.0	0	10.4	21	300	M	M	9		30	280
31	43	37	40	-3	25	0	T	0.0	0	12.6	20	30	M	M	10	1	24	20
=====																		
SM	1577	1077			680	0	3.48		3.2	326.1			M		232			
=====																		
AV	50.9	34.7								10.5	FASTST		M	M	7		MAX(MPH)	

Electronic Filing: Received, Clerk's Office 09/24/2020

MISC: ---> # 35 250 # 35 270

NOTES:

LAST OF SEVERAL OCCURRENCES

COLUMN 17 PEAK WIND IN M.P.H.

PRELIMINARY LOCAL CLIMATOLOGICAL DATA (WS FORM: F-6) , PAGE 2

STATION: CHICAGO-OHARE
MONTH: MARCH
YEAR: 2020
LATITUDE: 41 58 N
LONGITUDE: 87 54 W

[TEMPERATURE DATA] [PRECIPITATION DATA] SYMBOLS USED IN COLUMN 16

AVERAGE MONTHLY: 42.8 TOTAL FOR MONTH: 3.48 1 = FOG OR MIST
DPTR FM NORMAL: 4.9 DPTR FM NORMAL: 0.98 2 = FOG REDUCING VISIBILITY
HIGHEST: 67 ON 28, 8 GRTST 24HR 1.48 ON 28-28 TO 1/4 MILE OR LESS
LOWEST: 25 ON 7 3 = THUNDER
SNOW, ICE PELLETS, HAIL 4 = ICE PELLETS
TOTAL MONTH: 3.2 INCHES 5 = HAIL
GRTST 24HR 2.2 ON 22-22 6 = FREEZING RAIN OR DRIZZLE
GRTST DEPTH: 3 ON 23 7 = DUSTSTORM OR SANDSTORM:
VSBY 1/2 MILE OR LESS
8 = SMOKE OR HAZE

[NO. OF DAYS WITH] [WEATHER - DAYS WITH] 9 = BLOWING SNOW
X = TORNADO

MAX 32 OR BELOW: 0 0.01 INCH OR MORE: 11
MAX 90 OR ABOVE: 0 0.10 INCH OR MORE: 6
MIN 32 OR BELOW: 11 0.50 INCH OR MORE: 2
MIN 0 OR BELOW: 0 1.00 INCH OR MORE: 1

[HDD (BASE 65)]
TOTAL THIS MO. 680 CLEAR (SCALE 0-3) 1
DPTR FM NORMAL -161 PTCLDY (SCALE 4-7) 15
TOTAL FM JUL 1 5066 CLOUDY (SCALE 8-10) 15
DPTR FM NORMAL -509

[CDD (BASE 65)]
TOTAL THIS MO. 0
DPTR FM NORMAL -1 [PRESSURE DATA]
TOTAL FM JAN 1 0 HIGHEST SLP M ON M
DPTR FM NORMAL -1 LOWEST SLP 29.39 ON M

[REMARKS]
#FINAL-03-20#

Explanation of the Preliminary Monthly Climate Data (F6) Product

These data are preliminary and have not undergone final quality control by the National Climatic Data Center (NCDC). Therefore, these data are subject to revision. Final and certified climate data can be accessed at the NCDC - <http://www.ncdc.noaa.gov>.

WFO Monthly/Daily Climate Data

000
 CXUS53 KLOT 010700
 CF60RD
 PRELIMINARY LOCAL CLIMATOLOGICAL DATA (WS FORM: F-6)

STATION: CHICAGO-OHARE
 MONTH: APRIL
 YEAR: 2020
 LATITUDE: 41 58 N
 LONGITUDE: 87 54 W

TEMPERATURE IN F:		:PCPN:		SNOW:		WIND		:SUNSHINE:		SKY		:PK WND						
1	2	3	4	5	6A	6B	7	8	9	10	11	12	13	14	15	16	17	18
=====																		
12Z AVG MX 2MIN																		
DY	MAX	MIN	AVG	DEP	HDD	CDD	WTR	SNW	DPTH	SPD	SPD	DIR	MIN	PSBL	S-S	WX	SPD	DR
=====																		
1	53	38	46	2	19	0	0.00	0.0	0	7.0	13	60	M	M	6		18	60
2	61	34	48	4	17	0	T	0.0	0	5.0	14	70	M	M	3		20	80
3	70	46	58	14	7	0	T	0.0	0	6.5	14	280	M	M	9		19	270
4	52	37	45	0	20	0	0.06	0.0	0	7.5	16	320	M	M	8		22	320
5	52	35	44	-1	21	0	0.00	0.0	0	8.5	15	40	M	M	5		20	30
6	64	35	50	5	15	0	0.01	0.0	0	5.8	15	180	M	M	7		22	190
7	80	51	66	20	0	1	0.04	0.0	0	7.8	23	220	M	M	6	13	33	220
8	74	48	61	15	4	0	0.22	0.0	0	8.0	25	340	M	M	6	138	35	10
9	50	36	43	-3	22	0	T	T	0	17.9	32	310	M	M	3	5	47	290
10	50	33	42	-5	23	0	0.00	0.0	0	9.6	18	270	M	M	4		25	290
11	63	42	53	6	12	0	0.17	0.0	0	7.7	23	220	M	M	9		33	240
12	66	49	58	10	7	0	0.13	0.0	0	9.5	20	160	M	M	10	1	27	160
13	56	34	45	-3	20	0	0.02	0.0	0	17.0	29	300	M	M	7	1	42	300
14	41	30	36	-12	29	0	T	T	0	12.3	24	260	M	M	5		37	260
15	40	27	34	-15	31	0	0.10	1.7	1	8.2	17	290	M	M	8	1	24	260
16	47	28	38	-11	27	0	0.00	0.0	0	9.2	20	270	M	M	5		29	250
17	42	34	38	-12	27	0	0.29	3.0	2	7.8	16	40	M	M	8	18	20	40
18	59	34	47	-3	18	0	0.00	0.0	0	16.4	29	210	M	M	1		40	220
19	62	39	51	1	14	0	0.00	0.0	0	11.2	21	40	M	M	2		33	330
20	64	36	50	-1	15	0	0.04	0.0	0	12.6	28	230	M	M	3		43	260
21	53	36	45	-6	20	0	0.00	0.0	0	14.6	25	310	M	M	2		36	310
22	63	40	52	1	13	0	0.06	0.0	0	7.0	22	10	M	M	9		27	360
23	57	43	50	-2	15	0	T	0.0	0	7.6	17	360	M	M	10	8	21	20
24	50	40	45	-7	20	0	0.00	0.0	0	9.9	16	30	M	M	10	18	18	30
25	47	42	45	-7	20	0	0.19	0.0	0	12.7	22	20	M	M	10	1	28	30
26	63	41	52	-1	13	0	0.00	0.0	0	11.5	23	30	M	M	5		36	10
27	68	40	54	1	11	0	0.16	0.0	0	9.2	24	190	M	M	7	1	36	160
28	76	48	62	8	3	0	0.27	0.0	0	7.4	23	190	M	M	8	123	32	170
29	61	43	52	-2	13	0	1.89	0.0	0	10.7	30	340	M	M	10	1	41	340
30	56	42	49	-5	16	0	0.16	0.0	0	13.7	28	350	M	M	7	1	43	330
=====																		
SM	1740	1161			492	1	3.81		4.7	299.8			M		193			
=====																		
AV	58.0	38.7								10.0	FASTST		M	M	6		MAX(MPH)	
=====																		
MISC ----> # 32 310 # 47 290																		

Electronic Filing: Received, Clerk's Office 09/24/2020

NOTES:

LAST OF SEVERAL OCCURRENCES

COLUMN 17 PEAK WIND IN M.P.H.

PRELIMINARY LOCAL CLIMATOLOGICAL DATA (WS FORM: F-6) , PAGE 2

STATION: CHICAGO-OHARE
 MONTH: APRIL
 YEAR: 2020
 LATITUDE: 41 58 N
 LONGITUDE: 87 54 W

[TEMPERATURE DATA]

AVERAGE MONTHLY: 48.4
 DPTR FM NORMAL: -0.6
 HIGHEST: 80 ON 7
 LOWEST: 27 ON 15

[PRECIPITATION DATA]

TOTAL FOR MONTH: 3.81
 DPTR FM NORMAL: 0.43
 GRTST 24HR 1.89 ON 29-29
 SNOW, ICE PELLETS, HAIL
 TOTAL MONTH: 4.7 INCHES
 GRTST 24HR 3.0 ON 17-17
 GRTST DEPTH: 2 ON 17

SYMBOLS USED IN COLUMN 16

1 = FOG OR MIST
 2 = FOG REDUCING VISIBILITY
 TO 1/4 MILE OR LESS
 3 = THUNDER
 4 = ICE PELLETS
 5 = HAIL
 6 = FREEZING RAIN OR DRIZZLE
 7 = DUSTSTORM OR SANDSTORM:
 VSBY 1/2 MILE OR LESS
 8 = SMOKE OR HAZE
 9 = BLOWING SNOW
 X = TORNADO

[NO. OF DAYS WITH]

MAX 32 OR BELOW: 0
 MAX 90 OR ABOVE: 0
 MIN 32 OR BELOW: 3
 MIN 0 OR BELOW: 0

[WEATHER - DAYS WITH]

0.01 INCH OR MORE: 16
 0.10 INCH OR MORE: 10
 0.50 INCH OR MORE: 1
 1.00 INCH OR MORE: 1

[HDD (BASE 65)]

TOTAL THIS MO. 492
 DPTR FM NORMAL 0
 TOTAL FM JUL 1 5558
 DPTR FM NORMAL -509

CLEAR (SCALE 0-3) 4
 PTCLDY (SCALE 4-7) 16
 CLOUDY (SCALE 8-10) 10

[CDD (BASE 65)]

TOTAL THIS MO. 1
 DPTR FM NORMAL -8
 TOTAL FM JAN 1 1
 DPTR FM NORMAL -9

[PRESSURE DATA]

HIGHEST SLP M ON M
 LOWEST SLP 29.43 ON 12

[REMARKS]

#FINAL-04-20#

Explanation of the Preliminary Monthly Climate Data (F6) Product

These data are preliminary and have not undergone final quality control by the National Climatic Data Center (NCDC). Therefore, these data are subject to revision. Final and certified climate data can be accessed at the NCDC - <http://www.ncdc.noaa.gov>.

WFO Monthly/Daily Climate Data

210
 CXUS53 KLOT 010700
 CF60RD
 PRELIMINARY LOCAL CLIMATOLOGICAL DATA (WS FORM: F-6)

STATION: CHICAGO-OHARE
 MONTH: MAY
 YEAR: 2020
 LATITUDE: 41 58 N
 LONGITUDE: 87 54 W

TEMPERATURE IN F:		:PCPN:		SNOW:		WIND		:SUNSHINE:		SKY		:PK WND						
1	2	3	4	5	6A	6B	7	8	9	10	11	12	13	14	15	16	17	18
=====																		
12Z AVG MX 2MIN																		
DY	MAX	MIN	AVG	DEP	HDD	CDD	WTR	SNW	DPTH	SPD	SPD	DIR	MIN	PSBL	S-S	WX	SPD	DR
=====																		
1	68	38	53	-1	12	0	0.00	0.0	0	5.8	14	170	M	M	5		19	180
2	77	59	68	13	0	3	T	0.0	0	10.5	18	280	M	M	8		29	270
3	74	48	61	6	4	0	T	0.0	0	12.3	30	30	M	M	5		36	30
4	48	40	44	-12	21	0	0.00	0.0	0	16.2	24	30	M	M	8		32	20
5	49	40	45	-11	20	0	0.09	0.0	0	9.8	18	100	M	M	10		22	100
6	63	40	52	-4	13	0	0.00	0.0	0	8.0	15	40	M	M	6		20	40
7	66	45	56	0	9	0	0.00	0.0	0	10.4	24	280	M	M	4		37	280
8	46	34	40	-17	25	0	0.00	0.0	0	14.6	29	30	M	M	6		40	20
9	59	31	45	-12	20	0	0.00	0.0	0	10.8	21	250	M	M	2		29	240
10	55	37	46	-11	19	0	0.20	0.0	0	10.7	24	10	M	M	10	1	33	210
11	52	41	47	-11	18	0	T	0.0	0	7.4	16	360	M	M	8		22	350
12	63	41	52	-6	13	0	0.00	0.0	0	10.1	18	60	M	M	2		26	300
13	69	42	56	-2	9	0	0.08	0.0	0	11.4	21	100	M	M	5		30	150
14	73	54	64	5	1	0	3.53	0.0	0	7.9	16	170	M	M	9	13	23	170
15	79	54	67	8	0	2	0.68	0.0	0	7.8	23	290	M	M	9	13	33	260
16	67	50	59	0	6	0	0.56	0.0	0	11.7	20	30	M	M	8	1	25	50
17	68	53	61	2	4	0	3.11	0.0	0	8.4	18	150	M	M	10	13	26	140
18	64	53	59	-1	6	0	T	0.0	0	10.0	17	30	M	M	10	128	21	20
19	59	52	56	-4	9	0	0.25	0.0	0	13.7	22	20	M	M	10	1	26	30
20	66	53	60	0	5	0	0.00	0.0	0	11.3	21	80	M	M	7		29	80
21	70	57	64	3	1	0	0.00	0.0	0	6.8	17	80	M	M	9		24	80
22	72	57	65	4	0	0	T	0.0	0	4.3	12	90	M	M	8	18	16	60
23	82	55	69	8	0	4	0.52	0.0	0	8.7	17	130	M	M	6	13	26	140
24	90	64	77	15	0	12	0.00	0.0	0	6.1	13	140	M	M	6		13	140
25	88	69	79	17	0	14	0.18	0.0	0	8.9	17	200	M	M	8	18	17	200
26	89	68	79	17	0	14	0.07	0.0	0	8.6	23	130	M	M	6	3	23	130
27	87	72	80	18	0	15	0.03	0.0	0	6.7	15	190	M	M	8	38	15	190
28	82	62	72	9	0	7	0.21	0.0	0	10.1	26	330	M	M	9	18	28	330
29	76	58	67	4	0	2	T	0.0	0	11.1	24	330	M	M	5		30	330
30	73	54	64	0	1	0	0.00	0.0	0	8.3	14	320	M	M	3		21	300
31	69	50	60	-4	5	0	0.00	0.0	0	8.6	15	40	M	M	2		15	40
=====																		
SM	2143	1571			221	73	9.51		0.0	297.0			M		212			
=====																		
AV	69.1	50.7								9.6	FASTST		M	M	7		MAX(MPH)	

Electronic Filing: Received, Clerk's Office 09/24/2020

MISC: ---> # 30 '30 # 40 '20

NOTES:

LAST OF SEVERAL OCCURRENCES

COLUMN 17 PEAK WIND IN M.P.H.

PRELIMINARY LOCAL CLIMATOLOGICAL DATA (WS FORM: F-6) , PAGE 2

STATION: CHICAGO-OHARE
MONTH: MAY
YEAR: 2020
LATITUDE: 41 58 N
LONGITUDE: 87 54 W

[TEMPERATURE DATA] [PRECIPITATION DATA] SYMBOLS USED IN COLUMN 16

AVERAGE MONTHLY: 59.9
DPTR FM NORMAL: 0.8
HIGHEST: 90 ON 24
LOWEST: 31 ON 9
TOTAL FOR MONTH: 9.51
DPTR FM NORMAL: 5.83
GRTST 24HR 3.53 ON 14-14
SNOW, ICE PELLETS, HAIL
TOTAL MONTH: 0.0 INCH
GRTST 24HR 0.0
GRTST DEPTH: 0
1 = FOG OR MIST
2 = FOG REDUCING VISIBILITY TO 1/4 MILE OR LESS
3 = THUNDER
4 = ICE PELLETS
5 = HAIL
6 = FREEZING RAIN OR DRIZZLE
7 = DUSTSTORM OR SANDSTORM: VSBY 1/2 MILE OR LESS
8 = SMOKE OR HAZE
9 = BLOWING SNOW
X = TORNADO

[NO. OF DAYS WITH] [WEATHER - DAYS WITH]
MAX 32 OR BELOW: 0
MAX 90 OR ABOVE: 1
MIN 32 OR BELOW: 1
MIN 0 OR BELOW: 0
0.01 INCH OR MORE: 13
0.10 INCH OR MORE: 9
0.50 INCH OR MORE: 5
1.00 INCH OR MORE: 2

[HDD (BASE 65)]
TOTAL THIS MO. 221
DPTR FM NORMAL -4
TOTAL FM JUL 1 5779
DPTR FM NORMAL -513
CLEAR (SCALE 0-3) 4
PTCLDY (SCALE 4-7) 16
CLOUDY (SCALE 8-10) 11

[CDD (BASE 65)]
TOTAL THIS MO. 73
DPTR FM NORMAL 29
TOTAL FM JAN 1 74
DPTR FM NORMAL 20
[PRESSURE DATA]
HIGHEST SLP M ON M
LOWEST SLP 29.50 ON 31

[REMARKS]
#FINAL-05-20#

Explanation of the Preliminary Monthly Climate Data (F6) Product

These data are preliminary and have not undergone final quality control by the National Climatic Data Center (NCDC). Therefore, these data are subject to revision. Final and certified climate data can be accessed at the NCDC - <http://www.ncdc.noaa.gov>.

WFO Monthly/Daily Climate Data

956
 CXUS53 KLOT 010700
 CF60RD
 PRELIMINARY LOCAL CLIMATOLOGICAL DATA (WS FORM: F-6)

STATION: CHICAGO-OHARE
 MONTH: JUNE
 YEAR: 2020
 LATITUDE: 41 58 N
 LONGITUDE: 87 54 W

TEMPERATURE IN F:		:PCPN:		SNOW:		WIND		:SUNSHINE:		SKY		:PK WND						
1	2	3	4	5	6A	6B	7	8	9	10	11	12	13	14	15	16	17	18
=====																		
12Z AVG MX 2MIN																		
DY	MAX	MIN	AVG	DEP	HDD	CDD	WTR	SNW	DPTH	SPD	SPD	DIR	MIN	PSBL	S-S	WX	SPD	DR
=====																		
1	76	53	65	1	0	0	0.02	0.0	0	12.7	21	200	M	M	6		29	200
2	94	67	81	17	0	16	0.00	0.0	0	16.0	22	240	M	M	4		31	240
3	87	67	77	12	0	12	0.19	0.0	0	8.1	22	220	M	M	9	1	26	260
4	88	70	79	14	0	14	T	0.0	0	7.4	14	90	M	M	7	3	14	90
5	89	70	80	14	0	15	0.00	0.0	0	6.9	16	220	M	M	8		25	230
6	76	59	68	2	0	3	0.00	0.0	0	10.9	17	40	M	M	3		24	40
7	79	56	68	2	0	3	0.00	0.0	0	8.4	15	40	M	M	5		18	40
8	90	62	76	10	0	11	0.00	0.0	0	8.3	17	90	M	M	4		25	100
9	91	73	82	15	0	17	0.26	0.0	0	15.1	38	160	M	M	8	1	59	180
10	84	62	73	6	0	8	0.30	0.0	0	13.0	29	220	M	M	7	13	41	230
11	82	59	71	3	0	6	0.00	0.0	0	11.0	25	270	M	M	2		36	270
12	75	54	65	-3	0	0	T	0.0	0	8.2	21	10	M	M	3	3	27	10
13	66	52	59	-9	6	0	T	0.0	0	15.1	21	30	M	M	6		28	50
14	68	53	61	-8	4	0	0.00	0.0	0	10.0	16	60	M	M	2		23	60
15	73	52	63	-6	2	0	0.00	0.0	0	6.8	16	60	M	M	3		22	50
16	86	57	72	3	0	7	0.00	0.0	0	6.4	16	100	M	M	2		21	70
17	87	64	76	6	0	11	0.00	0.0	0	6.0	15	80	M	M	3		17	110
18	90	66	78	8	0	13	0.00	0.0	0	5.1	14	100	M	M	2		17	90
19	93	69	81	11	0	16	0.00	0.0	0	4.8	15	210	M	M	5		22	230
20	91	71	81	11	0	16	0.19	0.0	0	9.7	24	200	M	M	7	13	36	200
21	84	69	77	6	0	12	0.00	0.0	0	6.8	17	120	M	M	7		23	110
22	88	67	78	7	0	13	1.55	0.0	0	7.0	17	20	M	M	9	13	M	M
23	78	63	71	0	0	6	T	0.0	0	11.5	16	270	M	M	8		27	320
24	81	61	71	-1	0	6	0.04	0.0	0	7.0	18	310	M	M	6	3	23	270
25	86	62	74	2	0	9	0.00	0.0	0	6.5	16	310	M	M	4		20	310
26	81	70	76	4	0	11	1.55	0.0	0	7.7	40	330	M	M	9	13	53	330
27	88	72	80	8	0	15	0.00	0.0	0	7.4	15	220	M	M	7		20	240
28	85	72	79	6	0	14	0.00	0.0	0	6.2	16	100	M	M	6		16	100
29	93	72	83	10	0	18	0.30	0.0	0	7.6	28	360	M	M	7	13	36	350
30	91	73	82	9	0	17	T	0.0	0	6.5	17	60	M	M	8	3	23	100
=====																		
SM	2520	1917			12	289	4.40		0.0	264.1			M		167			
=====																		
AV	84.0	63.9								8.8	FASTST		M	M	6		MAX(MPH)	
=====																		
MISC ----> # 40 330 # 59 180																		

Electronic Filing: Received, Clerk's Office 09/24/2020

NOTES:

LAST OF SEVERAL OCCURRENCES

COLUMN 17 PEAK WIND IN M.P.H.

PRELIMINARY LOCAL CLIMATOLOGICAL DATA (WS FORM: F-6) , PAGE 2

STATION: CHICAGO-OHARE
 MONTH: JUNE
 YEAR: 2020
 LATITUDE: 41 58 N
 LONGITUDE: 87 54 W

[TEMPERATURE DATA]

[PRECIPITATION DATA]

SYMBOLS USED IN COLUMN 16

AVERAGE MONTHLY: 74.0
 DPTR FM NORMAL: 5.0
 HIGHEST: 94 ON 2
 LOWEST: 52 ON 15,13

TOTAL FOR MONTH: 4.40
 DPTR FM NORMAL: 0.95
 GRTST 24HR 1.55 ON 26-26
 SNOW, ICE PELLETS, HAIL
 TOTAL MONTH: 0.0 INCH
 GRTST 24HR 0.0
 GRTST DEPTH: 0

1 = FOG OR MIST
 2 = FOG REDUCING VISIBILITY
 TO 1/4 MILE OR LESS
 3 = THUNDER
 4 = ICE PELLETS
 5 = HAIL
 6 = FREEZING RAIN OR DRIZZLE
 7 = DUSTSTORM OR SANDSTORM:
 VSBY 1/2 MILE OR LESS
 8 = SMOKE OR HAZE
 9 = BLOWING SNOW
 X = TORNADO

[NO. OF DAYS WITH]

[WEATHER - DAYS WITH]

MAX 32 OR BELOW: 0	0.01 INCH OR MORE: 9
MAX 90 OR ABOVE: 8	0.10 INCH OR MORE: 7
MIN 32 OR BELOW: 0	0.50 INCH OR MORE: 2
MIN 0 OR BELOW: 0	1.00 INCH OR MORE: 2

[HDD (BASE 65)]

TOTAL THIS MO. 12	CLEAR (SCALE 0-3) 7
DPTR FM NORMAL -36	PTCLDY (SCALE 4-7) 20
TOTAL FM JUL 1 5791	CLOUDY (SCALE 8-10) 3
DPTR FM NORMAL -549	

[CDD (BASE 65)]

TOTAL THIS MO. 289	
DPTR FM NORMAL 124	[PRESSURE DATA]
TOTAL FM JAN 1 363	HIGHEST SLP M ON M
DPTR FM NORMAL 144	LOWEST SLP 29.28 ON 9

[REMARKS]

#FINAL-06-20#

Explanation of the Preliminary Monthly Climate Data (F6) Product

These data are preliminary and have not undergone final quality control by the National Climatic Data Center (NCDC). Therefore, these data are subject to revision. Final and certified climate data can be accessed at the NCDC - <http://www.ncdc.noaa.gov>.

WFO Monthly/Daily Climate Data

322
 CXUS53 KLOT 010700
 CF60RD
 PRELIMINARY LOCAL CLIMATOLOGICAL DATA (WS FORM: F-6)

STATION: CHICAGO-OHARE
 MONTH: JULY
 YEAR: 2020
 LATITUDE: 41 58 N
 LONGITUDE: 87 54 W

TEMPERATURE IN F:		:PCPN:		SNOW:		WIND		:SUNSHINE:		SKY		:PK WND						
1	2	3	4	5	6A	6B	7	8	9	10	11	12	13	14	15	16	17	18
=====																		
12Z AVG MX 2MIN																		
DY	MAX	MIN	AVG	DEP	HDD	CDD	WTR	SNW	DPTH	SPD	SPD	DIR	MIN	PSBL	S-S	WX	SPD	DR
=====																		
1	89	71	80	7	0	15	0.00	0.0	0	9.1	18	100	M	M	5		26	60
2	91	69	80	7	0	15	0.00	0.0	0	6.4	14	40	M	M	5		18	40
3	91	69	80	6	0	15	0.00	0.0	0	4.1	13	40	M	M	4		19	10
4	89	71	80	6	0	15	0.00	0.0	0	7.3	17	30	M	M	4	8	22	20
5	94	71	83	9	0	18	0.00	0.0	0	5.0	13	100	M	M	3		13	100
6	95	75	85	11	0	20	0.00	0.0	0	4.2	12	100	M	M	4	8	17	220
7	96	73	85	11	0	20	0.19	0.0	0	7.2	40	60	M	M	4	35	60	80
8	93	74	84	10	0	19	T	0.0	0	4.4	13	220	M	M	8		15	210
9	93	73	83	9	0	18	0.63	0.0	0	9.0	21	280	M	M	6	13	32	290
10	86	71	79	5	0	14	0.33	0.0	0	11.0	21	320	M	M	5	1	30	270
11	85	71	78	4	0	13	T	0.0	0	8.1	22	250	M	M	5		30	250
12	79	68	74	0	0	9	0.00	0.0	0	10.3	24	30	M	M	6		28	20
13	84	65	75	1	0	10	0.00	0.0	0	5.1	12	100	M	M	3		M	M
14	86	68	77	3	0	12	0.00	0.0	0	7.8	18	170	M	M	5		25	160
15	88	66	77	3	0	12	0.46	0.0	0	9.9	18	30	M	M	10	1	24	20
16	85	68	77	3	0	12	T	0.0	0	7.6	17	40	M	M	8		22	20
17	90	68	79	5	0	14	0.00	0.0	0	7.1	15	190	M	M	3		21	200
18	91	77	84	10	0	19	0.00	0.0	0	12.5	22	200	M	M	7		31	200
19	84	73	79	5	0	14	0.18	0.0	0	12.2	26	210	M	M	6	138	38	210
20	87	68	78	4	0	13	0.00	0.0	0	7.7	15	320	M	M	7		21	300
21	83	73	78	4	0	13	0.03	0.0	0	6.8	14	130	M	M	9		17	80
22	88	70	79	5	0	14	0.00	0.0	0	8.7	16	290	M	M	7		22	250
23	83	65	74	0	0	9	0.00	0.0	0	7.4	16	30	M	M	3		20	30
24	87	65	76	2	0	11	0.00	0.0	0	5.8	13	40	M	M	4		17	90
25	92	69	81	7	0	16	0.00	0.0	0	6.2	13	200	M	M	5		19	180
26	96	76	86	12	0	21	0.06	0.0	0	12.2	30	310	M	M	5	1	43	300
27	87	72	80	6	0	15	0.01	0.0	0	7.9	21	320	M	M	6		26	290
28	89	69	79	5	0	14	0.00	0.0	0	9.3	18	230	M	M	3		28	250
29	91	73	82	8	0	17	0.57	0.0	0	8.9	23	20	M	M	7	13	28	20
30	83	68	76	2	0	11	0.09	0.0	0	13.0	23	20	M	M	9	3	29	20
31	82	66	74	0	0	9	0.00	0.0	0	9.7	17	30	M	M	8		24	40
=====																		
SM	2737	2175			0	447	2.55	0.0	251.9				M		174			
=====																		
AV	88.3	70.2							8.1	FASTST	M	M	6		MAX(MPH)			

Electronic Filing: Received, Clerk's Office 09/24/2020

MISC: ---> # 40 '60 # 60 80

NOTES:

LAST OF SEVERAL OCCURRENCES

COLUMN 17 PEAK WIND IN M.P.H.

PRELIMINARY LOCAL CLIMATOLOGICAL DATA (WS FORM: F-6) , PAGE 2

STATION: CHICAGO-OHARE
MONTH: JULY
YEAR: 2020
LATITUDE: 41 58 N
LONGITUDE: 87 54 W

[TEMPERATURE DATA] [PRECIPITATION DATA] SYMBOLS USED IN COLUMN 16

AVERAGE MONTHLY: 79.2 TOTAL FOR MONTH: 2.55 1 = FOG OR MIST
DPTR FM NORMAL: 5.2 DPTR FM NORMAL: -1.15 2 = FOG REDUCING VISIBILITY
HIGHEST: 96 ON 26, 7 GRTST 24HR 0.63 ON 9- 9 TO 1/4 MILE OR LESS
LOWEST: 65 ON 24,23 3 = THUNDER
SNOW, ICE PELLETS, HAIL 4 = ICE PELLETS
TOTAL MONTH: 0.0 INCH 5 = HAIL
GRTST 24HR 0.0 6 = FREEZING RAIN OR DRIZZLE
GRTST DEPTH: 0 7 = DUSTSTORM OR SANDSTORM:
VSBY 1/2 MILE OR LESS

[NO. OF DAYS WITH] [WEATHER - DAYS WITH]
8 = SMOKE OR HAZE
9 = BLOWING SNOW
X = TORNADO

MAX 32 OR BELOW: 0 0.01 INCH OR MORE: 10
MAX 90 OR ABOVE: 12 0.10 INCH OR MORE: 6
MIN 32 OR BELOW: 0 0.50 INCH OR MORE: 2
MIN 0 OR BELOW: 0 1.00 INCH OR MORE: 0

[HDD (BASE 65)]
TOTAL THIS MO. 0 CLEAR (SCALE 0-3) 4
DPTR FM NORMAL -4 PTCLDY (SCALE 4-7) 24
TOTAL FM JUL 1 0 CLOUDY (SCALE 8-10) 3
DPTR FM NORMAL -4

[CDD (BASE 65)]
TOTAL THIS MO. 447
DPTR FM NORMAL 164 [PRESSURE DATA]
TOTAL FM JAN 1 810 HIGHEST SLP M ON M
DPTR FM NORMAL 308 LOWEST SLP 29.71 ON 9

[REMARKS]
#FINAL-07-20#

Explanation of the Preliminary Monthly Climate Data (F6) Product

These data are preliminary and have not undergone final quality control by the National Climatic Data Center (NCDC). Therefore, these data are subject to revision. Final and certified climate data can be accessed at the NCDC - <http://www.ncdc.noaa.gov>.

WFO Monthly/Daily Climate Data

022
 CXUS53 KLOT 010700
 CF60RD
 PRELIMINARY LOCAL CLIMATOLOGICAL DATA (WS FORM: F-6)

STATION: CHICAGO-OHARE
 MONTH: AUGUST
 YEAR: 2020
 LATITUDE: 41 58 N
 LONGITUDE: 87 54 W

TEMPERATURE IN F:		:PCPN:		SNOW:		WIND		:SUNSHINE:		SKY		:PK WND						
1	2	3	4	5	6A	6B	7	8	9	10	11	12	13	14	15	16	17	18
=====																		
12Z AVG MX 2MIN																		
DY	MAX	MIN	AVG	DEP	HDD	CDD	WTR	SNW	DPTH	SPD	SPD	DIR	MIN	PSBL	S-S	WX	SPD	DR
=====																		
1	80	69	75	1	0	10	T	0.0	0	7.7	14	30	M	M	9		18	30
2	86	67	77	3	0	12	0.05	0.0	0	7.8	28	360	M	M	7	3	38	20
3	72	61	67	-7	0	2	T	0.0	0	11.2	18	10	M	M	9		27	30
4	76	59	68	-6	0	3	0.00	0.0	0	8.6	20	360	M	M	3	8	25	360
5	78	56	67	-6	0	2	0.00	0.0	0	5.4	13	250	M	M	5	8	19	250
6	82	66	74	1	0	9	0.00	0.0	0	5.8	12	50	M	M	5		18	20
7	86	62	74	1	0	9	0.00	0.0	0	5.0	14	120	M	M	3	8	19	120
8	89	68	79	6	0	14	0.00	0.0	0	9.6	17	200	M	M	3		27	210
9	93	73	83	10	0	18	0.06	0.0	0	9.7	22	360	M	M	5	3	30	180
10	91	69	80	7	0	15	0.41	0.0	0	9.8	40	270	M	M	7	13	62	270
11	85	66	76	3	0	11	0.00	0.0	0	6.0	13	70	M	M	5		16	70
12	86	64	75	2	0	10	0.00	0.0	0	5.4	16	100	M	M	3		23	100
13	87	69	78	5	0	13	0.00	0.0	0	5.5	12	60	M	M	4		18	20
14	90	68	79	6	0	14	0.00	0.0	0	7.2	13	20	M	M	1		17	100
15	91	69	80	7	0	15	0.25	0.0	0	6.2	16	350	M	M	6	38	24	330
16	86	64	75	2	0	10	0.00	0.0	0	7.1	13	350	M	M	3		18	320
17	86	69	78	5	0	13	0.00	0.0	0	5.4	10	100	M	M	6		13	100
18	78	66	72	0	0	7	0.00	0.0	0	9.5	18	20	M	M	4		24	10
19	84	62	73	1	0	8	0.00	0.0	0	4.8	13	90	M	M	2		16	100
20	86	64	75	3	0	10	0.00	0.0	0	6.3	12	230	M	M	2		18	240
21	88	67	78	6	0	13	0.00	0.0	0	5.4	10	230	M	M	2		13	260
22	89	67	78	6	0	13	0.00	0.0	0	7.8	16	200	M	M	4		20	190
23	92	70	81	9	0	16	0.00	0.0	0	6.8	15	50	M	M	7	3	21	210
24	97	72	85	13	0	20	0.00	0.0	0	7.4	16	260	M	M	2	1	17	260
25	91	72	82	10	0	17	0.03	0.0	0	7.3	35	350	M	M	6	3	43	350
26	94	76	85	14	0	20	0.00	0.0	0	10.1	21	210	M	M	1		28	180
27	95	78	87	16	0	22	0.00	0.0	0	10.3	16	230	M	M	4		23	290
28	95	77	86	15	0	21	0.00	0.0	0	12.1	21	330	M	M	5		21	330
29	82	66	74	3	0	9	0.00	0.0	0	12.1	21	350	M	M	3		28	330
30	79	60	70	0	0	5	0.00	0.0	0	7.5	14	90	M	M	5		20	60
31	85	66	76	6	0	11	T	0.0	0	9.2	16	200	M	M	8		23	230
=====																		
SM	2679	2082			0	372	0.80		0.0	240.0			M		139			
=====																		
AV	86.4	67.2								7.7	FASTST		M	M	4		MAX(MPH)	

Electronic Filing: Received Clerk's Office 09/24/2020

MISC: ---> # 40 270 # 62 270

NOTES:

LAST OF SEVERAL OCCURRENCES

COLUMN 17 PEAK WIND IN M.P.H.

PRELIMINARY LOCAL CLIMATOLOGICAL DATA (WS FORM: F-6) , PAGE 2

STATION: CHICAGO-OHARE
MONTH: AUGUST
YEAR: 2020
LATITUDE: 41 58 N
LONGITUDE: 87 54 W

[TEMPERATURE DATA] [PRECIPITATION DATA] SYMBOLS USED IN COLUMN 16
AVERAGE MONTHLY: 76.8 TOTAL FOR MONTH: 0.80 1 = FOG OR MIST
DPTR FM NORMAL: 4.4 DPTR FM NORMAL: -4.10 2 = FOG REDUCING VISIBILITY
HIGHEST: 97 ON 24 GRTST 24HR 0.41 ON 10-10 TO 1/4 MILE OR LESS
LOWEST: 56 ON 5 3 = THUNDER
SNOW, ICE PELLETS, HAIL 4 = ICE PELLETS
TOTAL MONTH: 0.0 INCH 5 = HAIL
GRTST 24HR 0.0 6 = FREEZING RAIN OR DRIZZLE
GRTST DEPTH: 0 7 = DUSTSTORM OR SANDSTORM:
VSBY 1/2 MILE OR LESS
8 = SMOKE OR HAZE
9 = BLOWING SNOW
X = TORNADO

[NO. OF DAYS WITH] [WEATHER - DAYS WITH]
MAX 32 OR BELOW: 0 0.01 INCH OR MORE: 5
MAX 90 OR ABOVE: 10 0.10 INCH OR MORE: 2
MIN 32 OR BELOW: 0 0.50 INCH OR MORE: 0
MIN 0 OR BELOW: 0 1.00 INCH OR MORE: 0

[HDD (BASE 65)]
TOTAL THIS MO. 0 CLEAR (SCALE 0-3) 9
DPTR FM NORMAL -9 PTCLDY (SCALE 4-7) 20
TOTAL FM JUL 1 0 CLOUDY (SCALE 8-10) 2
DPTR FM NORMAL -13

[CDD (BASE 65)]
TOTAL THIS MO. 372
DPTR FM NORMAL 134 [PRESSURE DATA]
TOTAL FM JAN 1 1182 HIGHEST SLP M ON M
DPTR FM NORMAL 442 LOWEST SLP 29.62 ON 28

[REMARKS]
#FINAL-08-20#



The Village of
Glenview

Village Manager's Office
(847) 904-4370 direct
(847) 724-1518 fax

September 21, 2020

Michael Korman
2306 Sundrop Dr
Glenview, IL 60026

Re: Freedom of Information Act Response

Dear Mr. Korman:

On September 14, 2020, the Village of Glenview received your Freedom of Information Act ("FOIA") request (the "Request") seeking the following records:

"I am seeking a copy of the Notice of Intent (aka NOI) for the IDOT managed roadway project located at the Willow Road bridge which overflies Metra lines and Patriot Boulevard. This is an Illinois EPA form which IDOT is required to file with the Village of Glenview per the NPDES permit process (Part II E)."

The Village does not possess any records responsive to your request.

The Village's Freedom of Information Officer, after consultation with other Village personnel familiar with the subject records, is responsible for the above response.

You have the right to seek review of this response by contacting the Public Access Counselor of the Office of the Attorney General at 500 S 2nd St, Springfield, IL 62706, (217) 558-0486 or publicaccess@atg.state.il.us, within 60 days of this letter's date. You also have the right to judicial review of this decision by filing an action in the Circuit Court of Cook County, Illinois.

Sincerely,
Lisa Goodwin
Freedom of Information Act Officer